



16th EASTS
CONFERENCE
2025

PROGRAMME BOOK

THE 16 EASTS CONFERENCE 2025

Surakarta, 1 - 4 September

*Harnessing Local Wisdom and Green Technology to
Build a Sustainable Transport Sector in Eastern Asia*

Organized by



MASYARAKAT
TRANSPORTASI
INDONESIA



UNS
UNIVERSITAS
SEBELAS MARET



©BIONMOTRET

Organized by



MASYARAKAT
TRANSPORTASI
INDONESIA



UNS
UNIVERSITAS
SEBELAS MARET



KEMENTERIAN PERBUHASAN DAN
REPUBLIK INDONESIA



©BIONMOTRET

**20
25
EASTS**

Conference Program

01 Sambutan
(*Welcome Remarks*)

08 Tentang Konferensi
(*About the EASTS*)

09 Penyelenggara Acara
(*The Committee*)

21 Tentang Tuan Rumah
(*About Host City*)

22 Rangkaian Acara
(*Conference Agenda*)

25 Lokasi Kegiatan
(*Conference Venue*)

27 Seremoni Pembuka
(*Opening Ceremony*)

30 Sesi Teknis
(*Technical Sessions*)

86 Informasi Peserta
(*Participants Information*)

87 Kegiatan Tambahan
(*Side Events*)

88 Kirab Budaya
(*Cultural Parade*)

89 Jamuan Malam
(*Gala Dinner*)

Organized by



MASYARAKAT
TRANSPORTASI
INDONESIA



UNS
UNIVERSITAS
SEBELAS MARET



©BIONMOTRET

GREETINGS

Akimasa Fujiwara
8th President of EASTS



Distinguished guests, colleagues, and friends,

It is my great honor to welcome you to the 16th International Conference of the Eastern Asia Society for Transportation Studies (EASTS).

As you know, EASTS is an **academic community of researchers** from across Asia, focusing on transportation issues unique to this region. In Asia, where diverse cultures intersect and rapid growth continues, EASTS has long contributed by **disseminating research findings and nurturing** the next generation of scholars.

A distinctive feature of EASTS is its network-based organizational structure, composed of domestic societies from various countries and regions. When a researcher joins their national society, they automatically become a regular member of EASTS. As of July 2025, EASTS comprises 19 member societies with more than 2,000 active members.

In 2024, EASTS celebrated its 30th anniversary with a memorable event in November. It was a valuable opportunity to reflect on our history and explore the future direction of the society. As part of this celebration, we conducted interviews with distinguished leaders such as former President Professor Morichi, Professor Inamura, Professor Ishida, and Professor Yai — pioneers who established, supported, and nurtured EASTS. Their reflections allowed us to reaffirm the founding vision of the society and to receive inspiring messages for its future. These records will soon be made publicly available.



I am also pleased to share encouraging news. Our peer-reviewed open-access journal, Asian Transport Studies (ATS), published by Elsevier, has recently been indexed in the Emerging Sources Citation Index (ESCI) and has achieved an Impact Factor of 2.2. This is a remarkable milestone and a testament to the collective efforts of our entire community.

Finally, let me emphasize that the biennial international conference is the most important activity of EASTS. At a time when the world faces division and conflict, it is more important than ever for researchers in Asia to cross borders, share knowledge, and work together to envision the future of transportation and society. I am therefore truly delighted that the 16th EASTS International Conference is being held this year in Solo, Indonesia.

This conference has been made possible through the dedication and hard work of the Local Organizing Committee and all those involved. I wish to express my deepest gratitude and highest respect to them.

Akimasa Fujiwara
8th President of EASTS

GREETINGS

Tory Damantoro, S.T., MPPM, M.Sc
Chairman of The Indonesian Transportation Society



Great honor to welcome you to The 16th EASTS Conference 2025, held in the historic city of Surakarta, Indonesia. This conference serves as a strategic platform for scholars, researchers, policymakers, and practitioners to exchange knowledge, share best practices, and strengthen collaboration in advancing sustainable transportation across Eastern Asia.

As an organization committed to developing research-based transportation policies, the Indonesian Transportation Society (MTI) views EASTS as an important arena to showcase the synergy between academia, government, and practitioners. Through this synergy, we aim to promote smart, inclusive, and environmentally sustainable transportation solutions that address both regional and global challenges. May this conference inspire innovative ideas, strengthen networks, and generate impactful outcomes for the future of transportation in our region.

In closing, I encourage all participants to make the most of this opportunity to share your knowledge, expand networks, and contribute to shaping a more inclusive and sustainable future for transportation in Eastern Asia.

GREETINGS

Hartono
The Rector of
Sebelas Maret University (UNS)



On behalf of Universitas Sebelas Maret (UNS), it is my great honor and privilege to welcome all distinguished guests, researchers, policymakers, and practitioners to the **16th EASTS Conference 2025** held in Surakarta, Indonesia. We are truly delighted to host this prestigious gathering at our university, bringing together a vibrant community of experts committed to advancing sustainable transportation across Eastern Asia.

The theme of this year's conference, "*Harnessing Local Wisdom and Green Technology to Build a Sustainable Transport Sector in Eastern Asia*", resonates deeply with our shared vision for the future. In an era of rapid urbanization and climate change, transportation is not only about mobility. It is about building sustainable connectivity that supports economic growth, social equity, and environmental stewardship. By combining cutting-edge green technology with the rich local wisdom embedded in our communities, we can create transport systems that are inclusive, resilient, and future-oriented.

As an institution dedicated to research, innovation, and community engagement, Universitas Sebelas Maret is proud to support this significant forum. We believe that bridging theory and practice is essential in shaping policies and solutions that can be applied in real-world scenarios. Hosting EASTS 2025 provides us with a valuable opportunity to foster international collaboration, exchange knowledge, and strengthen our collective efforts in building smarter and greener transportation systems.



I would like to express my sincere appreciation to the **Eastern Asia Society for Transportation Studies (EASTS)**, the **Indonesian Transportation Society (MTI)**, the **Ministry of Transportation of the Republic of Indonesia**, the **Government of Central Java Province**, the **Government of Surakarta City**, and **all our academic partners, professional associations, industry collaborators, and supporting organizations** whose commitment and cooperation have made this conference possible. Your contributions exemplify the power of partnership in advancing sustainable transportation.

May this conference be an insightful platform for learning, collaboration, and innovation. I wish all participants an inspiring and productive experience during your visit to Universitas Sebelas Maret and in the culturally vibrant city of Surakarta.

Welcome to **UNS**, and welcome to **16th EASTS Conference 2025**.

Hartono

The Rector of Sebelas Maret University (UNS)

GREETINGS”

Prof. Bagus Hario Setiadji
Chairman of the Conference Committee



On behalf of the Conference Committee, it is with great pleasure that we extend a warm welcome to all distinguished speakers, participants, guests, and colleagues to the 16th Conference of the Eastern Asia Society for Transportation Studies (EASTS) in Surakarta.

Established in 1994, EASTS is dedicated to the advancement of transportation research, practice, and knowledge exchange across East Asia and the world. The EASTS Conference, a cornerstone of the Society's activities, is now held for the sixteenth time. We are honored that Surakarta has been entrusted as the host city for this prestigious event, following its successful edition in Surabaya in 2009.

This conference has convened over 550 participants from 28 countries, reflecting a significant growth in the Society's reach and influence, with attendance nearly doubling since the 2009 conference in Surabaya. The academic program has been designed to facilitate robust intellectual engagement, featuring two keynote forums, nine technical sessions, and a series of side events and pre-conference activities. We also extend our sincere gratitude to the City Government of Surakarta and Universitas Sebelas Maret (UNS) for their invaluable support and partnership in hosting this conference..



It is our foremost hope that this conference will serve as a dynamic platform for the exchange of innovative ideas, foster rigorous academic discourse, and strengthen professional networks among researchers and practitioners. We are committed to ensuring that the deliberations over the coming days will contribute meaningfully to the body of knowledge in transportation science and inspire future collaborations.

We would like to take this opportunity to acknowledge and thank all the partners, sponsors, and individuals whose unwavering support has been essential in bringing this conference to fruition.

Let us collectively engage in this event to collaborate and innovate for the future of sustainable transportation.

We wish you a successful and productive conference.

Prof. Bagus Hario Setiadji
Chairman of the Conference Committee

ABOUT EASTS



The Eastern Asia Society for Transportation Studies (EASTS) plays a pivotal role in advancing transportation research and policy development across East Asia. One of its primary functions is **facilitating academic collaboration and knowledge exchange** through its biennial international conferences, which **serve as a platform for scholars, practitioners, and policymakers to discuss emerging transportation challenges and innovations.**

Furthermore, EASTS provides a scholarly publication platform, disseminating high-quality research through journals such as Asian Transport Studies, Journal of the EASTS, and Proceedings of the EASTS.

KEY ROLES OF EASTS IN TRANSPORTATION RESEARCH AND POLICY



Facilitating academic collaboration and knowledge exchange



Providing a platform for scholarly publications



Advancing research in transport planning, policy, and infrastructure development.

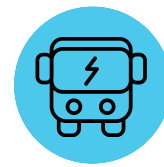

Promoting sustainable and smart transportation solutions



Contributing to data-driven policy formulation

OUR MEMBER



Australia



Lao PDR



Mongolian



New Zealand



Kamboja



Hongkong



Korea



Vietnam



Cina



Indonesia



Nepal



Thailand



Singapura



Japan



Srilanka



Philippines



Malaysia



Taiwan



Myanmar

COMMITTEES

BOARD OF DIRECTORS



President	Akimasa FUJIWARA (Japan)
1st Vice-President	Yu-Chiun CHIOU (Taiwan)
2nd Vice-President	Tory DAMANTORO (Indonesia)
Secretary-General	Shinya HANAOKA (Japan)
Treasurer	Daisuke FUKUDA (Japan)
ISC Chairperson	Saksith CHALERMPONG (Thailand)
Representatives of Domestic Societies	Li MENG (Australia)
	Monyrath KOV (Cambodia)
	Derong WANG (China)
	S.C. WONG (Hong Kong)
	Tory DAMANTORO (Indonesia)
	Atsushi FUKUDA (Japan)
	Jeong Whon YU (Korea)
	Mohamed Rehan KARIM (Malaysia)
	Asralt BUYANTSOGT (Mongolia)
	Khin Than YU (Myanmar)
Hare Ram SHRESTHA (Nepal)	

COMMITTEES

EX-OFFICIO MEMBERS



President Emeritus	Hideo NAKAMURA (Japan)
Former Presidents	Primitivo C. CAL (Philippines)
	Shigeru MORICHI (Japan)
	Kyung Soo CHON (Korea)
	Cheng-Min FENG (Taiwan)
	Tetsuo YAI (Japan)
	Jaehak OH (Korea)

COMMITTEES

INTERNATIONAL SCIENTIFIC COMMITTEE (ISC)



<p>Chairperson</p>	<p>Prof. Saksith CHALERMPONG</p>
<p>Topic Group Chief & Co-Topic Group Chief</p>	<p>Dr. Sittha JAENSIRISAK Dr. Prasongchai Setthasuravich Dr. Inhi KIM Prof. Jason CC LU Dr. Abdul Azeez Kadar HAMSA Dr. Timo Eccarius Dr. Win Trivitayanurak Prof. Chien-Hung WEI Prof. Ghim Ping ONG Prof. Bhargab MAITRA Dr. Yu-Ting HSU Dr. Tony NN SZE Prof. Kun-Feng (Ken) WU Dr. Manoj Lohatepanont Dr. Saroch Boonsiripant</p>
<p>Chief Reviewers</p>	<p>Dr. Amila Buddhika JAYASINGHE Dr. Ankit GUPTA Dr. Hirohisa KAWAGUCHI Dr. Hua WANG Dr. Jia YANG Dr. Minh Tan DANG Dr. Sittha JAENSIRISAK Dr. Sudarmanto Budi NUGROHO Dr. Tissa U LIYANAGE Dr. Tzu-Chang LEE Dr. Phathinan THAITHATKUL Prof. Chih-Peng CHU Dr. Dinh Van HIEP Dr. Li MENG Dr. Pradeepa JAYARATNE Dr. T L GUNARUWAN Dr. Timo ECCARIUS Dr. Yapa Mahinda BANDARA Dr. Yuee GAO Prof. Zhiwei WANG Prof. Sugiarto Mr. Faza Fawzan BASTARIANTO Dr. Putu HERMAWATI Dr. Alfa NARENDRA Dr. Anak Agung Gde KARTIKA Prof. An Minh Ngoc Dr. Arnab JANA Dr. Hoang-Tung NGUYEN Dr. Hooi Ling KHOO Dr. Kasem CHOOCHARUKUL Dr. Ngoc Dung BUI Dr. Thillaiampalam SIVAKUMAR (SIVA) Dr. Tien Dung CHU</p>

COMMITTEES

INTERNATIONAL SCIENTIFIC COMMITTEE (ISC)



Chief Reviewers

Dr. Tien Dung CHU
Dr. Tsung-Hsien TSAI
Dr. Wahyu Herijanto
Dr. Purnawan
Dr. Mukhammad Rizka Fahmi Amrozi
Dr. Andyka Kusuma
Prof. Muhammad Zudhy Irawan
Dr. Gloria Novita Christin
Dr. Andy H.F. CHOW
Dr. Kuancheng HUANG
Dr. Lincoln WOOD
Dr. Muhammad Nashir ARDIANSYAH
Dr. Niles PERERA
Dr. Noor Mahmudah
Dr. Juang Akbardin
Dr. Febri Zukhruf
Dr. Truong Thi My Thanh
Dr. Ang LI
Dr. Ilham Malik
Dr. Probo Hardini
Prof. Mudjiastuti Handajani
Dr. Gusti Ayu Andani
Dr. Maya Safira
Prof. Manoranjan PARIDA
Dr. Matthew Ian BURKE
Dr. Nirajan SHIWAKOTI
Dr. Norlida Abdul HAMID
Dr. Sylvia HE
Dr. Vu Anh TUAN
Dr. Muchammad Zaenal Muttaqin
Prof. Anastasia Caroline Sutandi
Prof. Jachrizal Sumabrata
Dr. Budi Yulianto
Prof. Hera Widiastuti
Dr. Jamshid I. SODIKOV
Prof. Meng GUO
Dr. Nattaporn CHAROENTHAM
Dr. Yu-Min SU
Prof. Nyoman Arya Thanaya
Prof. Ludfi Djakfar
Dr. Ervina Ahyudanari
Prof. Ary Setyawan
Prof. Bagus Hario Setiadji
Dr. Debasis BASU
Dr. Hiroaki NISHIUCHI
Dr. Tetsuhiro ISHIZAKA
Dr. K. Ramachandra RAO
Dr. Ka Io WONG
Dr. Kinjal BHATTACHARYYA
Dr. Long TRUONG
Dr. Prakash RANJITKAR
Prof. Yanli MA

COMMITTEES

INTERNATIONAL SCIENTIFIC COMMITTEE (ISC)



Chief Reviewers

Dr. Niranga AMARASINGHA
Dr. Qiang ZENG
Dr. Shane TURNER
Dr. Shih-Hsuan HUANG
Dr. Weijie WANG
Dr. Wonchul KIM
Dr. Yanyong GUO
Dr. Yi-Shih CHUNG
Prof. Yu-Chiun CHIOU
Dr. Aine Kusumawati
Dr. Fanyu MENG
Dr. Haojie LI
Dr. Law Teik HUA
Dr. Ying LEE
Dr. Taqia Rahman
Dr. Akira HOSOMI
Prof. Yi John SUN
Dr. William WANG
Dr. Indika IGERA
Dr. Jinseo PARK
Dr. Shin-ichi SAITO
Dr. Patanapong Sanghatawatana
Dr. Ornicha Anuchitchanchai

COMMITTEES

ISC SECRETARIAT



ISC Secretariat	Name	Local Society
ISC Chairperson	Prof. Saksith CHALERMPONG	Thailand
ISC ATS & Awarding Sub- committee	Prof. Y.C. CHIOU	Taiwan
ISC Chief Secretariat	Prof. Kunawee KANITPONG	Thailand
ISC Secretariat	Dr. Yosuke UCHIYAMA	Japan/Thailand
ISC Chief of Recruitment Sub-committee	Assoc. Prof. Ampol KAROONSOONTAWONG	Thailand
ISC Information Officer	Assoc. Prof. Varameth VICHENSAN	Thailand
ISC Chief of Paper Management Sub- committee	Dr. Phathinan THAITHATKUL	Thailand

COMMITTEES

ISC PAPER MANAGEMENT SUB-COMMITTEE



Name	Affiliation	Position
Dr. Phathinan Thaithatkul	Chulalongkorn University Transportation Institute	Chief of PMC
Dr. Yosuke Uchiyama	Chulalongkorn University Transportation Institute	Paper Reviewer Coordinator
Dr. Ali Anjomshoae	Chulalongkorn University Transportation Institute	Program Coordinator
Piyaphat Chaemchuen, M.Sc.	Chulalongkorn University Transportation Institute	Editorial System Manager
Dr. Kanyarat Nimtrakool	Chulalongkorn University Transportation Institute	Database Management Officer
Dr. Lisa Kenney	Chulalongkorn University Transportation Institute	International Liaison

COMMITTEES

STEERING COMMITTEE



Chairman

Tory Damantaro, ST, MPP, MSc
(Chairman of Ketua Umum Masyarakat Transportasi Indonesia)

Members

Prof. Ir. Suyono Dikun, MSc, PhD
Prof. Ir. Bambang Susantono , M.C.P., M.S.C.E., Ph.D.
Prof. Dr. Techn. Ir. Danang Parikesit, MSc, IPU, ASEAN Eng
Prof. Dr. Ir. Agus Taufik Mulyono, MT, IPU, ASEAN Eng
Prof. Dr. Hartono, dr, MSi
Prof Dr. Rivan A. Purwantono, MH
Arief Suhartono
Pradana Murti, ST, MSc
DR (HC) Noni Sri Ayati Purnomo, BEng, MBA
Muhammad Fauzan, MT, MM
Muhammad Awwaludin, MBA
Irawati Hermawan, SH, MH
Polana Pramesti, MT
Ir. Milatia Kusuma, MBA

COMMITTEES

CONFERENCE ORGANIZING COMMITTEE



Chairman

Prof. Bagus Hario Setiadji, ST, MT, PhD

Vice Chairman

Erry Derima Ryanto, ATD, MT(Central Java Provincial Transportation Agency)
Kombes Pol. Sonny Irawan, SIK, MH (Directorate of Traffic of the Central Java Regional Police)

Deputy Chairperson for External Committee

Dr. Ir. Haris Muhammadun, ATD, MM, IPU

Deputy Chairperson for Internal Committee

Prof. Ir. Ary Setyawan, MSc, PhD

Deputy Chairperson for Cooperation with Surakarta City

Ir. Muhammad Taufik S, SiT, MT

Secretaries

Dr. Alfa Narendra, ST, MT
Yusa Cahya Permana, ST, MSc
Ir. Budi Yulianto, ST, MSc, PhD

Treasurers

Ir. Dina Hakiki, MT
Lydia Novitriana Nur Hidayati, ST, MSc, PhD
Ferlijana, SE, MM

External Committee for Board Member and Keynote/Invited Speaker

Andyka Kusuma, S.T., M.Sc., Ph.D
Prof. Dr. Eng., Ir. Muhammad Zudhy Irawan, ST, MT

Protocols

Ir. Budi Yulianto, S.T., M.Sc., Ph.D.
Muhammad Taufik
Sunarto

Public relations, publication, documentation

Ir. Djoko Setijowarno, M.T.
Darmaningtyas

COMMITTEES

CONFERENCE ORGANIZING COMMITTEE



Media and Website

Dr. Adjat Wiratma, SH, MPd
Maryani
Ir. Setiono, ST, MSc
Dwiastuti, SKom (Public Relation UNS)

EXPO

Arinova G. Utama, ST, MT
Sayid Mataram, SSn, MSn
Ibnu Danar

Internal Committee: Scientific

Prof. Dr. Eng. Ir. Muhammad Zudhy Irawan, ST, MT
Dr. Eng., Ir. Febri Zukhruf, ST, MT

Internal Committee: Seminar kit, souvenir, goodie bag, door prize, memento

Dr. Ir. Edy Purwanto, S.T., M.T. (and Students)
Raden Ajeng Dinasty Puromoasri, S.T., M.T.

Program

Dr. Ir. Bambang Setiawan, ST, MT
Dr. Edy Purwanto, ST, MT
Dr. Ir. F Pungky Pramesti, ST, MT
Dr. Ir. Fajar Handayani, ST, MT

Transportation and Excursion

Dr. Ir. Bambang Setiawan, ST, MT (and Students)
Dr. Ir. Edy Purwanto, ST, MT
Travel Biro
UNS Security Team

Accommodation and Venue

Ir. Tuti Agustin, MEng
Lydia Novitriana Nur Hidayati, ST, MSc, PhD
Dr Galuh Chrismaningwang, ST, MT
Angga (UNS Tower)

Equipment and Documentation

Dr. Ir. Edy Purwanto, ST, MT
Reza Muhammad Razzan

Expo

Yoga Asmara, SH, MH

Medical Care

Dr. Selfi Handayani, dr., M.Kes
(Head of Medical Center UNS)

ABOUT MTI



Established in 1995, the Indonesian Transportation Society (MTI) is a non-profit professional organization dedicated **to advocate sustainable transport in Indonesia.**



MASYARAKAT TRANSPORTASI INDONESIA

MTI is **prominent partners for the Indonesian Government and stakeholders in policy making process**, to implement sustainable transport policies based on research, policy dialogues, and public awareness campaigns.



With 21 chapters and 400 members nationwide, **MTI engages transportation professionals to address Indonesia's transportation challenges sustainably through research, policy dialogues, and public awareness campaigns**, both domestic and international.

THE CHAIRMAN OF INDOONESIAN TRANSPORTATION SOCIETY (MTI)



Suyono Dikun
Ketua MTI 2004- 2007



Bambang Susantono
Ketua MTI 2007- 2010



Danang Parikesit
Ketua MTI 2010- 2016



Agus Taufik Mulyono
Ketua MTI 2016- 2022



Tory Damantoro
Ketua MTI 2022-2025

INFORMATION

www.mti.or.id

@masyarakattransportasi

@sinergi_mti

Masyarakat Transportasi Indonesia

Masyarakat Transportasi Indonesia

Masyarakat Transportasi Indonesia

OUR WORKING PARTNER



OUR ASSOCIATION PARTNER



ABOUT HOST CITY



Surakarta City (Javanese: Hanacaraka: ꦱꦸꦫꦏꦂꦠ, Pegon: سوراكارتا, Chinese: 梭罗市, Javanese pronunciation: [suro 'kartə]), also known as Solo (Javanese: ꦱꦺꦴꦭꦲ translit. Sala, Javanese pronunciation: [sɔɭə]), is a city in Central Java Province, Indonesia, covering an area of 44.04 km². In 2020, Surakarta had a population of 522,364, with a density of 11,861 people/km², and by the end of 2024, the population was 589,242.



It is the third largest city in southern Java, after Malang, East Java, and Bandung, West Java, based on population. The eastern part of the city is traversed by a river immortalized in the keroncong song, Bengawan Solo. The city is part of the Greater Solo (Solo Raya) area, serving as its main city.

Together with Yogyakarta, Surakarta is an heir to the Islamic Mataram Kingdom, which was divided through the Giyanti Treaty in 1755, making Surakarta the residence of Susuhunan Pakubuwana and Adipati Mangkunegara



CONFERENCE AGENDA

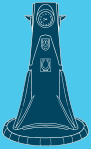

DAY 1

Monday, 1 September 2025

GPH Haryo Kusumo Auditorium UNS

TIME	DURATION	ACTIVITY
07.30 - 08.00	30 minutes	Registration
08.00 - 08.25	25 minutes	Coffee/Tea Break - Networking
08.25 - 09.25	60 minutes	OPENING CEREMONY
08.25 - 08.35	10 minutes	Welcoming by MC
08.35 - 08.40	5 minutes	National Anthem Indonesia Raya
08.40 - 08.45	5 minutes	Chairman's Report: Prof. Bagus Hario S., S.T., M.T., Ph.D.
08.45 - 08.50	5 minutes	Welcoming Speech: Rector of UNS Prof. Dr. Hartono, dr., M.Si.
08.50 - 08.55	5 minutes	Welcoming Speech: Chief of MTI, Tory Darmantoro, S.T., MPPM., M.Sc.
08.55 - 09.00	5 minutes	Greeting Speech: President KOTI (Rep of Domestic Society) Dr. Kim Young-chan
09.00 - 09.05	5 minutes	President of EASTS' Report: Prof. Akimasa Fujiwara
09.05 - 09.25	20 minutes	Keynote Speaker and Opening Remark: Indonesia's Minister of Transportation (Represented by Vice Minister of Transportation)
09.25 - 11.25	120 minutes	High Level Session 1: Moderator: Prof. Bambang Susantono, Panelist: Prof. Bhargab Maitra Invited Speaker 1: Prof. Yusak Octavius Susilo (BOKU University, Vienna, Austria) Invited Speaker 2: Prof. Makoto Chikaraishi (Hiroshima University, Japan)
11.25 - 13.30	125 minutes	Lunch break - Networking
13.30 - 15.00	90 minutes	Technical Session - 1
15.00 - 15.30	30 minutes	Coffee/Tea Break - Praying Time
15.30 - 17.00	90 minutes	Technical Session - 2
17.00 - 18.00	60 minutes	Depart to Gala Dinner Venue
18.30 - 20.30	120 minutes	Gala Dinner: Hosted by Government of Surakarta (For invited participant)

CONFERENCE AGENDA

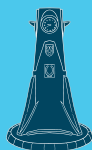

DAY 2

Tuesday, 2 September 2025

UNS Tower and UNS Inn

TIME	DURATION	ACTIVITY
08.00 - 09.00	60 minutes	Registration
09.00 - 11.00	120 minutes	High Level Session 2: Moderator Prof. Danang Parikesit, Panelist: Prof. Hironori Kato Invited Speaker 1: Prof. Ronghui Liu (University of Leeds, United Kingdom) Invited Speaker 2: Prof. Tim Schwanen (University of Oxford, United Kingdom)
09.00 - 11.00	120 minutes	Side Event 1: Strategy for Expanding Digital Payment Systems in Public Transport Services in Indonesia
11.00 - 12.30	90 minutes	Technical Session - 3
11.00 - 12.30	90 minutes	Side Event 2: Enhancing Indonesia's Urban Climate Resilience through Sustainable and Inclusive Transport
12.30 - 13.30	60 minutes	Lunch break and Praying Time
13.30 - 15.00	90 minutes	Side Event 3: Strategy for Implementing Safety Management Systems in Public Transport Companies toward Safer Mobility
13.30 - 15.00	90 minutes	Technical Session - 4
15.00 - 15.30	30 minutes	Coffee/Tea Break and Praying Time
15.30 - 17.00	90 minutes	Technical Session - 5
19.00 - 21.00	120 minutes	Board Meeting

CONFERENCE AGENDA

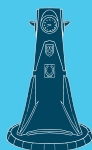

DAY 3

Wednesday, 3 September 2025

UNS Tower and UNS Inn

TIME	DURATION	ACTIVITY
08.00 - 09.00	60 minutes	Registration
09.00 - 10.30	90 minutes	Side Event 4: Strategy for Developing Environmentally Friendly Transport toward Sustainable Mobility
09.00 - 10.30	90 minutes	Technical Session - 6
10.30 - 11.00	30 minutes	Coffee/Tea Break
11.00 - 12.30	90 minutes	Technical Session - 7
12.30 - 13.30	60 minutes	Lunch Break and Praying Time
13.30 - 15.00	90 minutes	Technical Session - 8
13.30 - 15.00	90 minutes	Book Review
15.00 - 15.30	30 minutes	Coffee/Tea Break
15.30 - 17.00	90 minutes	Technical Session - 9
17.00 - 18.30	90 minutes	Closing Ceremony
18.30 - 20.30	120 minutes	Farewell Dinner

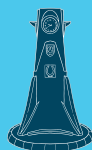

OTHERS MEETING

Schedule of EASTS Board Meetings

Board Meeting 1 (Representative Assembly Meeting – RAM)

Date: Sunday 31 August 2025

Time: 17:00-19:00

Venue: Executive Lounge, UNS Tower, 11th Floor
(access by private elevator only)

Board Meeting 2

Date: Tuesday 2 September 2025

Time: 19:00-21:00

Venue: Executive Lounge, UNS Tower, 11th Floor
(access by private elevator only)

Schedule of ISC Meeting

Date: Tuesday 2 September 2025

Time: 17:00-18:30

Venue: Executive Dining Room, UNS Tower, 11th Floor
(access by private elevator only)

LOCATION

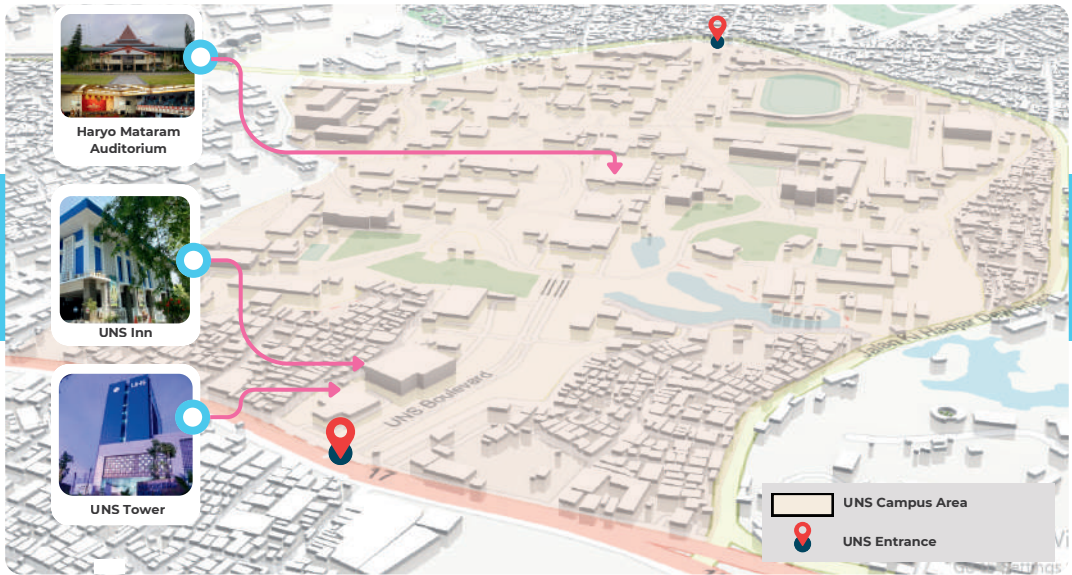

ROOM AND FACILITIES

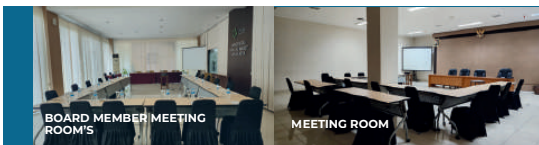
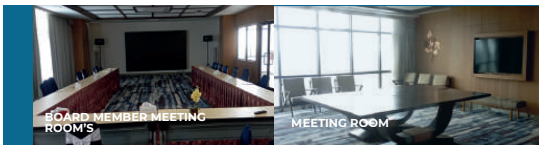
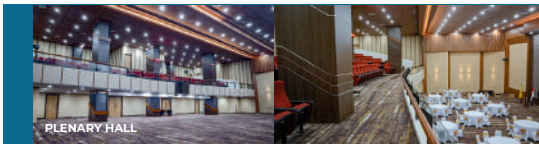

Floor 2nd UNS Tower



Floor 3rd UNS Tower (Ballroom)

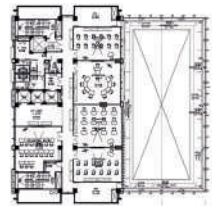

Floor 5th UNS Tower

OVERVIEW

EVENT VENUE

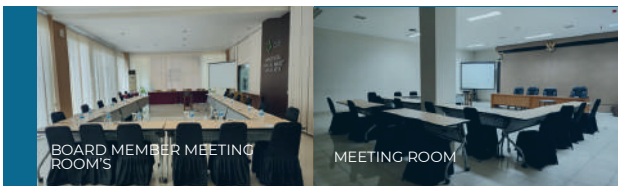
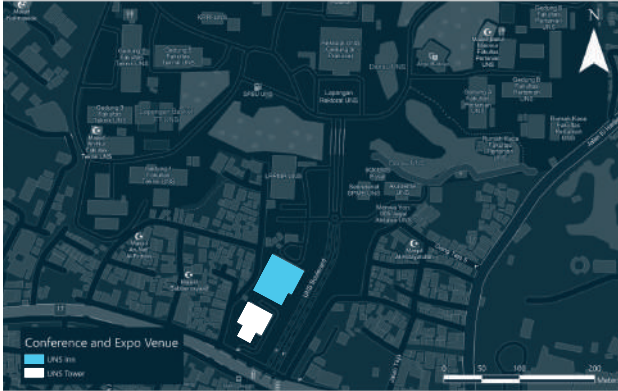

OPENING CEREMONY



OPENING CEREMONY

 **Haryo Mataram Auditorium**

 **1 September 2025**

The opening of the conference featuring speech from UNS rector, president of EASTS, Chair of MTI, as well as the report from the organizing committee. The conference will officially open by the Minister for Transportation of Republic of Indonesia.

WELCOME AND KEYNOTE SESSION



Akimasa Fujiwara
8th President of EASTS



Tori Damantoro
Chair of MTI



Dr. Dudy Purwagandhi, S.T., M.T.
The Minister of Transportation



Hartono
Rector of UNS



Bagus Hario
Chair of OC

The keynote speaker is the The Minister of Transportation, Dudy Purwagandhi, will provide high-level perspectives on sustainable transportation in Indonesia and how it connects with global context, also the vision of promoting sustainable transportation through green technology and local wisdom.

HIGH-LEVEL SESSION 1

High-Level Session 1



Haryo Mataram Auditorium



**08.25-10.30
1 September 2025**

An academic forum where researchers present their latest studies on transportation, covering topics such as smart mobility, urban planning, and the integration of renewable energy into transportation systems. In addition to knowledge-sharing, the forum offers mentorship opportunities during dedicated technical sessions, where experienced professionals and academics provide guidance to participants, helping them translate research insights into practical applications and innovative solutions.



Prof. Yusak Octavius Susilo
BOKU University, Vienna, Austria



Moderator
Prof Bambang Susantono



Prof. Makoto Chikaraishi
Hiroshima University, Japan



Panelist
Prof Bhargab Maitra

HIGH-LEVEL SESSION 2

High-Level Session 2

 **UNS Tower**
Ballroom, 3 Floor

 **08.25-10.30**
2 September 2025

An academic forum where researchers present their latest studies on transportation, covering topics such as smart mobility, urban planning, and the integration of renewable energy into transportation systems. In addition to knowledge-sharing, the forum offers mentorship opportunities during dedicated technical sessions, where experienced professionals and academics provide guidance to participants, helping them translate research insights into practical applications and innovative solutions.



Prof. Ronghui Liu
University of Leeds, UK



Moderator
Prof. Danang Parikesit



Prof. Tim Schwanen
University of Oxford, UK



Panelist
Prof. Hironori Kato

TECHNICAL SESSION



UNS Tower & UNS Inn



1-3 September 2025

An academic forum where researchers present their latest studies on transportation, covering topics such as smart mobility, urban planning, and the integration of renewable energy into transportation systems. In addition to knowledge-sharing, the forum offers mentorship opportunities during dedicated technical sessions, where experienced professionals and academics provide guidance to participants, helping them translate research insights into practical applications and innovative solutions.

Room	Sep 1, 2025			Sep 2, 2025				Sep 3, 2025			
	11:00-12:30	13:30-15:00	15:30-17:00	09:00-10:30	11:00-12:30	13:30-15:00	15:30-17:00	09:00-10:30	11:00-12:30	13:30-15:00	15:30-17:00
UNS Tower, Vocational Classroom1, 2nd floor	N/A	5 Papers	5 Papers	N/A	5 Papers	5 Papers	4 Papers	5 Papers	5 Papers	4 Papers	5 Papers
UNS Tower, Vocational Classroom2, 2nd floor	N/A	5 Papers	4 Papers	N/A	5 Papers	5 Papers	5 Papers	5 Papers	4 Papers	4 Papers	3 Papers
UNS Tower, Ballroom, 3rd floor	N/A	5 Papers	5 Papers	N/A	4 Papers	5 Papers	4 Papers	N/A	N/A	N/A	N/A
UNS Tower, Meeting Room2, 5th floor	N/A	5 Papers	5 Papers	N/A	5 Papers	5 Papers	5 Papers	5 Papers	4 Papers	4 Papers	4 Papers
UNS Tower, Meeting Room3, 5th floor	N/A	5 Papers	4 Papers	N/A	5 Papers	5 Papers	5 Papers	5 Papers	4 Papers	4 Papers	5 Papers
UNS Inn, Jodhipati Room, 2nd floor	N/A	5 Papers	5 Papers	N/A	5 Papers	5 Papers	5 Papers	4 Papers	3 Papers	4 Papers	5 Papers
UNS Inn, Giripurna Room, 2nd floor	N/A	5 Papers	4 Papers	N/A	5 Papers	5 Papers	5 Papers	5 Papers	5 Papers	5 Papers	N/A
UNS Inn, Indrakila Room, 2nd floor	N/A	N/A	5 Papers	N/A	5 Papers	5 Papers	5 Papers	5 Papers	5 Papers	4 Papers	N/A
UNS Inn, Madukara Room, 2nd floor	N/A	4 Papers	3 Papers	N/A	5 Papers	5 Papers	5 Papers	5 Papers	5 Papers	5 Papers	N/A
UNS Inn, Indraprastha Room, 2nd floor	N/A	4 Papers	6 Papers	N/A	N/A	N/A	N/A	N/A	N/A	N/A	N/A
Total	N/A	43 Papers	46 Papers	N/A	44 Papers	45 Papers	43 Papers	39 Papers	35 Papers	34 Papers	22 Papers

Session 1, Session Number 1 (13:30-15:00)

Session Chair: Bhargab Maitra

NO	PAPER ID	TITLE	AUTHOR	AFFILIATION
1	PP4171	Development of Speed Management Policy for Enhancing Road Safety: An Experience from the State of West Bengal, India	Sankhadeep Pramanik; Abhishek Chakraborty; Uday Shankar; Bhargab Maitra	Indian Institute of Technology Kharagpur
2	PP4337	Injury Severity of Traffic Accident in Japan's Metropolitan Areas: Hotspots Analysis in Tokyo, Nagoya, and Osaka	Blawal Hussain, PhD; Gerhard PARZINGER; Kenji ISOMOTO; Masaya Nakano; Hironori KATO	Pacific Consultants Co Ltd
3	PP4216	Estimating the Critical Gap for U-Turns at Uncontrolled Median Openings	Porntep Puangprakhon, Ph.D.; Walairat Bunthai	Mahanakorn University of Technology
4	PP4004	Single-vehicle impact speed modelling from vehicle tracking and injury crash data: A case study of Addis-Adama Toll Road, Ethiopia	Gemechu Yilikal Mose, MSc; Shinji TANAKA	Yokohama National University Institute of Urban Innovation
5	PP4053	Comparative Analysis of Drivers' Injury Severity in Passenger Car-Light Motor Truck Crashes: Elderly vs. Non-Elderly Drivers in Fukuoka Prefecture, Japan	Jia Yang, Ph.D.; Toshiyuki Yamamoto; Ryosuke Ando; Motohiro Yamazaki	Toyota Transportation Research Institute

Session 2, Session Number 11 (15:30-17:00)

Session Chair: Isti Hidayati

NO	PAPER ID	TITLE	AUTHOR	AFFILIATION
1	PP4040	Investigating cycling behavior in cities of car-oriented culture	Isti Hidayati	Gadjah Mada University Faculty of Engineering
2	PP3993	Factors Influencing Bicycle Usage and Development of a Proposed Bike Network for Yangon	Nanda Kyaw Win, Master of Engineering	Yangon Technological University
3	PP3903	Characterizing Sri Lankan Cyclists: A Data-Driven Approach to Cycling Behavior	Piumi Jayasena; Ganga Samarasekera; Champika Ellawala; Sajith Udayanga	University of Sri Jayewardenepura
4	PP4152	Risk Factors and Behavioral Predictors of Motorcycle Near-Crashes, Crashes, and Informal Settlements: A Data-Driven Analysis	Glenn LATONERO; Sandy Gaspay; Reyna Remotin; Cheryl Brides	University of the Philippines Diliman
5	PP4133	Effects of Pavement Distresses on Cyclist Behavior: Observations in Metro Manila	Lea Bronuela-Ambrocio; John Eric Calma; Emmanuel LESACA; Sandy Mae Gaspay, Ph.D.	UP Diliman: University of the Philippines Diliman

Session 1, Session Number 2 (13:30-15:00)

Session Chair: Sorawit Narupiti

NO	PAPER ID	TITLE	AUTHOR	AFFILIATION
1	PP4099	The Inclusion of Land Use and Zoning Regulations in Autonomous Vehicle Development in Indonesia: A Case Study of Denpasar, Bali	Nur Diana Safitri; Ibnu Syabri; I Gusti Ayu Andani	INSTITUT TEKNOLOGI SUMATERA
2	PP4062	LLM-Based Scenario Generation for Automated Vehicle-Pedestrian Accidents	Jihun KANG; Jihyung PARK; Woori KO; Byungkyu PARK; Ilsoo YUN	Ajou University
3	PP3857	Autonomous Vehicles: A Global Review of Research Trends, and Real-World Implementation	Takumi Ogino; Naohiro KITANO; Akinori MORIMOTO	Waseda University - Nishiwaseda Campus
4	PP4388R1	Endeavors in Sustainable Public Transportation Services Using Affordable and Simple Autonomous Vehicles with Resident Cooperation for Local Governments with Small Budgets	Ryo Yamanaka, Toshiaki MIYAGUNI, Naohiko HIBINO, Daisuke KAMIYA, Nobuo SEKI, Shigeru MORICHI	University of the Ryukyus
5	PP3867	Optimal Toll Setting Model Considering the Spread of Semi-Autonomous Vehicles with Variable Driving Modes Within a Trip	Sorachi Matsumoto, B. E.; Shuto KURIHARA; Ryuichi TANI; Kenetsu UCHIDA	Hokkaido University Faculty of Engineering

Session 2, Session Number 12 (15:30-17:00)

Session Chair: Ryuichi Tani

NO	PAPER ID	TITLE	AUTHOR	AFFILIATION
1	PP4130	Effect of Road Gradient and Traffic Performance on Speed of BRT Trans Jateng (Case Study: Corridor 1 and 3)	Amelia Kusuma Indriastuti; Bagus Hario Setiadji; Alfa Narendra; Ryan Miftahul Rizky; Galang Abdi Wicaksono; Syifaa Nur Halizah Oktafiana	Diponegoro University Faculty of Engineering
2	PP4232	Assessing the Network Efficiency and Environmental Impact of the EDSA Busway under Transport and Traffic Measures: A Microsimulation and Mobile Crowdsourcing Approach	Lester Jay Ventura Ollero, M.Sc.; Karl Vergel; Noriel Christopher Tiglao	University of the Philippines Diliman
3	PP4145	Enhancing Urban Mobility: A Bus Rapid Transit (BRT) System Plan for Iloilo City	Max Aldea del Rosario; Keith CAMENA; Ronald CARTAGENA; Max DEL ROSARIO c; Hermilo GOSUICO; Alexis FILLONE	De la Salle University Gokongwei College of Engineering
4	PP4116	'Mind the Gap': Investigating the Relationship between Mode Transfer Quality Index (MTQI) and Passenger Mode Transfer Satisfaction Score (PMTSS) in EDSA Busway, Philippines	Ann Camille Fajardo, Sandy Mae Gaspay	SafeTravelPH Mobility Innovations Organization

Session 1, Session Number 3 (13:30-15:00)

Session Chair: Yurie Toyama

NO	PAPER ID	TITLE	AUTHOR	AFFILIATION
1	PP4088	The Quality of Bicycle Infrastructure in Yogyakarta City: A Case of Suroto Bicycle Lane	imma widyawati agustin, Ph.D.; Imma Widyawati AGUSTIN; Risma KHOIRUNNISA; Fauzul SUTIKNO	Universitas Brawijaya
2	PP4132	Determination of Minimum One-Way Bicycle Lane Width Considering Cyclists Maneuvers	Ryan Ramde Maguddayao; Isnigo Wynnet Alvarez; Sandy Mae Gaspay	University of the Philippines Diliman
3	PP4054	Comparative Analysis of Public Bicycle Usage Pattern	Wooyong Sim, Byongchan SHIN, Hyunju SHIN, Gunwoo LEE, Hiroaki INOKUCHI	Kansai University
4	PP4231	Identifying the transport role of shared bike: A case study of Taoyuan City, Taiwan	Barbara T.H. Yen, Ph.D.; Tsai-Jung Yu; Pin-Ying Ho; Yi-Jou Tsai	National Yang Ming Chiao Tung University
5	PP4342	Self-Balancing Docked Bike Sharing Systems for Urban Green Mobility: Real-World Hidden Demand Reconstruction and User-Based Optimization	Yu-Shin Hu; I-Yun Lisa Hsieh; Jian Hern Yeoh	National Taiwan University

Session 2, Session Number 13 (15:30-17:00)

Session Chair: Asmita Pokhrel

NO	PAPER ID	TITLE	AUTHOR	AFFILIATION
1	PP3892	SR4S and Road Safety in Nepalese Schools: Evaluating Risk Factors and Effective Interventions	Asmita Pokhrel, Hemant Tiwari, Sanjay Luitel	Traffic and Transport Unlimited Solutions
2	PP4082	Ranking Highway Accident Black Spots Using Time Series Trend Analysis, Kernel Density Estimation, and Principal Component Analysis: A Case Study on Thai Highways	Htet Wint Htay, M.Eng(Civil); Natachai Wongchavalidkul	Mahidol University
3	PP4173	Traffic Accident Risk Analysis Considering Road Environment Factors	Mio Hosoe; Masashi Kuwano; Yuka Minamino	Tottori University; Tottori Daigaku
4	PP4380	Machine Learning-Based Modeling for Ground-Level Visibility Prediction	NOBEL DHARMAWAN; Hung-Jui Lin; I-Yun Lisa Hsieh	National Taiwan University
5	PP4141	Value of Risk Reduction of Fatal Road Crashes: A Case Study of Long- and Medium- Route Public Vehicle Passengers	Rojee Pradhananga; Puspa SUKUBHATTU; Padma SHAHI	Tribhuvan University Institute of Engineering Pulchowk

Session 1, Session Number 4 (13:30-15:00)

Session Chair: Yu-Ting Hsu

NO	PAPER ID	TITLE	AUTHOR	AFFILIATION
1	PP4345	A Supervised Deep Learning Model for Optimizing Vehicle-to-Building Energy Management: Case Study on Electric Scooter Battery Swap Stations	Jian Hern Yeoh; Yu-Shin Hu; I-Yun Lisa Hsieh	National Taiwan University
2	PP4111	Towards Sustainable Public Transportation: Evaluating the Carbon Reduction Potential of E-Jeepneys in the Philippines	Job Immanuel B Encarnacion, Lanz Matthew Joaquin Ang, John Lian Mar Catli	University of the Philippines Diliman
3	PP4256	Evaluating the Spatial Layout of Public Charging Infrastructure for Electric Taxis Using GPS Trajectory Data	Meng Liu; Sylvia He	The Chinese University of Hong Kong
4	PP4377	Exploring Charging Behavior of Electric Vehicle Drivers for Strategic Deployment of Public Chargers	Yu-Ting Hsu, Kevin Tandra, Chao-Jung Chen	National Taiwan University
5	PP4306	Can electric vehicles deliver sustainable mobility in low-income countries?	Zia Wadud, Shams Tanvir	University of Leeds

Session 2, Session Number 14 (15:30-17:00)

Session Chair: Rojee Pradhananga

NO	PAPER ID	TITLE	AUTHOR	AFFILIATION
1	PP4066	Evaluation of Public Transportation Projects with Equity Considerations: Preliminary Findings from Mamminasata, Indonesia	Hajriyanti Yatmar; Ryosuke ABE	Yokohama National University Institute of Urban Innovation
2	PP3934	QOL and QOB Accessibility-Based Evaluation Method for Air-front Smart Cities Application: Startup and Post Harvest Agriculture Cases	Mustafa Mutahari, M.D.; Nao SUGIKI; Giolo MABABANGLOOB; Ronnie CONCEPCION; Marla MANIQUIZ-REDILLAS; Yoshitsugu HAYASHI	Toyohashi University of Technology; Toyohashi Gijutsu Kagaku Daigaku
3	PP4044	Economic Impacts of Traffic Congestion in Kathmandu Valley: A 2021 Cost Assessment	Rojee Pradhananga; Aayush Maan Karki; Pratik Sapkota; Anil Marsani	Tribhuvan University Institute of Engineering Pulchowk Campus
4	PP3914	Estimation of Social Return on Investment in Regional Public Transportation of a Japanese Suburban Area	Tetsuaki Matsunaga; Kento YOH; Kenji DOI; Yasuchika AOKI	Osaka University; Osaka Daigaku
5	PP4268	Assessing the Impact of Rail Accessibility on Land Value Dynamics: The Case Study of Metro Manila Light Rail Transit Line 2	Carl Dave Maraya Silos; Sandy Mae Gaspay	University of the Philippines Diliman

Session 1, Session Number 5 (13:30-15:00)

Session Chair: Teppei Kato

NO	PAPER ID	TITLE	AUTHOR	AFFILIATION
1	PP3872	Emergency Response Accessibility in Coastal Cities: An analysis of the Impact of Storm Surges and Sea Level Rise	Geronimo Pulido; Fumitaka Kurauchi; Tomonao Kobayashi; Shuya Murase; Kouhei Araki	Gifu University
2	PP4015	Autonomous Truck-Drone Delivery for Disaster Relief with a Tabu Search Solution Algorithm	Li-Wen CHEN; Ta-Yin HU; Guan-Jie HUANG	National Cheng Kung University
3	PP4378	Evaluation of Household Relocation Policy Affecting Urban Mobility under Riverine Flood Using an Activity-Based Model in Ubon Ratchathani, Thailand	Noriyasu Tsumita, Ratthanaporn KAEWKLUENGLOM, Sideney SCHREINER, Sittha JAENSIRISAK, Atsushi FUKUDA	Kanazawa University
4	PP3925	Simulation Analysis of Hospital Ship Placement Strategies During Large-Scale Disasters	Taro ARATANI; Takahiro MAJIMA	National Institute of Maritime, Port and Aviation Technology, Japan

Session 2, Session Number 15 (15:30-17:00)

Session Chair: Mathew Harvey Tongol Peralta

NO	PAPER ID	TITLE	AUTHOR	AFFILIATION
1	PP4375	Potential Co-Benefits of Electrification in Taiwan: Impacts on Air Quality, Health, and Carbon Emissions	Hung-Jui Lin; Dennis Kao; I-Chun Tsai; I-Yun Lisa Hsieh	National Taiwan University
2	PP3883	Towards Achieving Carbon Neutrality in Passenger Cars: Optimal Choice between BEVs and Carbon-Neutral ICEVs based on Threshold Traveled Distances	Mathew Harvey T Peralta, MA; Yasunori Muromachi	University of the Philippines Diliman
3	PP4178	Decarbonization Road Transport Sector through electro mobility in Asia Pacific Region Reviews EVs Strategies and Policies in AP region to achieve Net-Zero 2050	Sudarmanto Budi NUGROHO	Institute for Global Environmental Strategies
4	PP4184	Decarbonisation of road transport in sub-national level in Indonesia: case study Jakarta City, West Java Province and Semarang City, Indonesia	Sudarmanto Budi NUGROHO; Junichi Fujino; Tomoko Ishikawa	Institute for Global Environmental Strategies; Koeki Zaidan Hojin Chikyu Kankyo Senryaku Kenkyu Kikan
5	PP3936	The Purchase Intention of Electric Motorcycles: A Survey of Public Perception in Malaysia	GUANYU XIE; Lilis Surlenty	Universiti Sains Malaysia

Session 1, Session Number 6 (13:30-15:00)

Session Chair: Barbara Tzu-Hui Yen

NO	PAPER ID	TITLE	AUTHOR	AFFILIATION
1	PP4302	The Impact of Value Creation in Maritime Logistics on Economic Development: A System Dynamics Perspective	Andri Mubarak; Satya Sahoo; Dong-Wook Song	University of Indonesia: Universitas Indonesia
2	PP4215	Optimizing Route Selection in Liner Shipping Networks: Linear Programming Approach	Kazuhiko ISHIGURO, Daiki TATEISHI, Mikio TAKEBAYASHI, Yoshihisa SUGIMURA	Kobe University
3	PP4085	Effect of the Geographical Extent of Hinterland on Container Throughputs	Kentaro Kan; Taro ARATANI; Tomoya KAWASAKI; Naoyuki TOMARI; Tomoyuki TODOROKI; Keisuke YOSHIOKA	Nihon University: Nihon Daigaku
4	PP3989	Evaluation of Sea Transportation Connectivity and its Impact on Economic Development in the Maluku Archipelago Area, Indonesia	Nur Hidayah Djaimin, M.GES; Minori TOKITO; Satoshi ASANO	Kyoto University - Yoshida Campus: Kyoto Daigaku
5	PP4167	Systematic Literature Review on Transport Connectivity and Trade: A Meta-analysis Approach	Barbara T.H. Yen, Ph.D.; Kuan-Cheng Huang; Sin-Hao Chen	National Yang Ming Chiao Tung University

Session 2, Session Number 16 (15:30-17:00)

Session Chair: Siti Raudhatul Fadilah

NO	PAPER ID	TITLE	AUTHOR	AFFILIATION
1	PP4074	Enhanced Vehicle Detection in Aerial Images Using YOLO with Adaptive Scaling Feature Pyramid Network	Ngoc Dung Ngoc BUI, Ph.D; Huy Hoang PHAM; Thu Huyen LE; Sellappan PALANIAPPAN	University of Transport and Communications
2	PP3959	Design Innovation of Information System Integration for Passenger Density Detection on Electric Rail Trains through Infrared Sensors based on ESP32 Microcontroller as an Effort to Optimize Passenger Equality between Carriages	Sindy Allaam Claudia, Resty ARYAHIRATURAHMA H, Putri Wiradhika ZEBUA, Sri SARJANA, Femmy Sofie SCHOUTEN, Avi Mukti AMIN	POLITEKNIK TRANSPORTASI DARAT INDONESIA
3	PP4007	Real-Time Traffic Information Influences on Motorbike Route Choice Behavior: A Link-Based Analysis	Siti Raudhatul Fadilah, Ph.D.; Hiroaki Nishiuchi; An Minh Ngoc	Sriwijaya University Faculty of Engineering: Universitas Sriwijaya Fakultas Teknik
4	PP4190	Development of a Video-based Real-Time Passenger Boarding and Alighting Counting System for buses to Reduce Fare Evasion under Varying Camera Angles and Operating Conditions	Suman Ganguly, M.Tech; Sai Santosh Metta; Bhargab Maitra	IIT Kharagpur: Indian Institute of Technology Kharagpur
5	PP4243	Optimization of Traffic Signal Maintenance Performance: A Case Study of Hsinchu City Using DEA and Tobit Regression	Hsin Yu Wang; Barbara T.H. YEN; Jin-Yuan WANG	National Yang Ming Chiao Tung University

Session 1, Session Number 7 (13:30-15:00)

Session Chair: Ryusuke Takeuchi

NO	PAPER ID	TITLE	AUTHOR	AFFILIATION
1	PP4304	Travel Demand Forecasting for a New Public Transportation System Between Tashkent and New Tashkent	Farrukh Almanov; Almanov Shukhratovich; Ryosuke ABE	Yokohama National University; Yokohama Kokuritsu Daigaku
2	PP4206	An Initial Investigation on the Possible Impact of One Ayala Terminal to the Trip Behavior of Commuters	Konstantine Chua Koh, MA; Crispin DIAZ; Angeli MARZAN	University of the Philippines Diliman
3	PP3865	The Influence of the Fare of Municipal Community Transport Systems on Local Communities in Japan	Ryusuke TAKEUCHI, Ph.D; Masayosi TANISHITA	Chuo University - Korakuen Campus; Chuo Daigaku - Korakuen Campus
4	PP4042	Correlation of Light and Metro Rail Passenger Service Quality Perception to Sociodemographic Factors and Travel Behavior	David Angelo Mauro Valenzuela; Uzziah GALERO; Dane UY; Nicanor ROXAS	De la Salle University Gokongwei College of Engineering
5	PP4163	Residents Preferences and Use Intentions for a New BHLS-DRT Public Transport System in Sapporo	Yuta Mishina, M.D.; Kunihiro KISHI; Shin-ei TAKANO	Hokkaido University Faculty of Engineering; Hokkaido Daigaku Kogakubu Daigakuin Kogakuin Kogaku Kenkyuin

Session 2, Session Number 17 (15:30-17:00)

Session Chair: Huong Thi Thanh Nguyen

NO	PAPER ID	TITLE	AUTHOR	AFFILIATION
1	PP4117	Determining a Zoning Regulation based on Parking Vehicle Characteristics. A Circumstances in Kupang City, East Nusa Tenggara Province, Indonesia	Don Gaspar Noesaku DA COSTA, Eldo Marlino Fransisco DA COSTA	Universitas Katolik Widya Mandira, Kupang
2	PP4151	Develop a multi-criteria methodology to evaluate and recommend the best sustainable option of public parking infrastructure planning in the Eastern Asia downtown	Huong Thi Thanh NGUYEN, Ph.D; Anh Tuan VU	University of Transport and Communications
3	PP4021	A Study on Parking Situation and Parking Reform Potential in Luang Prabang, Lao People's Democratic Republic	Kotaro Tsuchiya	Japanese International Cooperation Agency Research Institute
4	PP3860	Parking Standard for South Korea Based on Parking Difficulty	Sungjun Kim; Kyum Hur; Beomkyu Bae; Jeongwhon Yu	Ajou University

Session 1, Session Number 8 (13:30-15:00)

Session Chair: Sunkyung Choi

NO	PAPER ID	TITLE	AUTHOR	AFFILIATION
1	TBC	Shared Mobility Services in Japan: Current Status and Key Issues	Sunkyung Choi	Gunma University, Japan
2	TBC	Shared Mobility Services in Korea: Current Status, Issues and Recommendations	Jeongran Wee; Hee Cheol Shin	Korea Transport Institute (KOTI), Korea
3	TBC	Shared mobility services in Taiwan: Current Status and Key Issues	Y.-C. Chiou	National Yang-Ming Chiao Tung University

Session 2, Session Number 18 (15:30-17:00)

Session Chair: Napon Srisakda

NO	PAPER ID	TITLE	AUTHOR	AFFILIATION
1	PP4052	An Alternative Framework to Capture the Day-To-Day Traffic Flow Evolution After an Unexpected Network Disruption	Hasintha Nawod Kalpana Lindamullage Don Charls; Teppei KATO; Kazushi SANO	Nagaoka University of Technology
2	PP4070	Creating User Profile of NEMT Travelers for Kanagawa Prefecture, Japan using K-Means Clustering Algorithm	Lucy Mariel Lopez Quiroga, M.D.; Shinji Tanaka	Yokohama National University; Yokohama Kokuritsu Daigaku
3	PP3963	ESTIMATION OF EXPANSION COEFFICIENT OF TRIP CHAIN BY USING GPS AND MOBILE PHONES LOCATION INFORMATION	Makoto Tsukai, Ph.D	Hiroshima University
4	PP3893	A Macroscopic Analysis of the Effect of Toll Plaza Road Marking on Drivers' Merging Behavior: A Pre-Post Study in Odaka TB, Japan	Mutia Lisya; Kojiro Matsuo; Ryohei Homma; Aoto Mimuro; Makoto Kasai; Nao Sugiki	Toyohashi University of Technology; Toyohashi Gijutsu Kagaku Daigaku
5	PP3887	Big data approach to short-term bus speed-based prediction of urban road traffic congestion	Anh Tuan Vu; Minh Thong Nguyen	Vietnamese-German University

Session 1, Session Number 9 (13:30-15:00)

Session Chair: Hoai Nguyen Pham

NO	PAPER ID	TITLE	AUTHOR	AFFILIATION
1	PP4014	Operational-Stage Modifications for Hairpin Curves: Evidence from Driving Behavior Analysis	Vasantha WICKRAMASINGHE, Muditha GUNARATHNA, Hasanka WIJESUNDARA	University of Peradeniya, Sri Lanka
2	PP4150	Traffic Safety Education for Adolescent Cyclists: A Scoping Review Bibliometric Analysis	Hoai Nguyen Phama, Anukul Nidhib, Yogeshwar V Navandar, Tú Anh Trinh	University of Economics Ho Chi Minh City
3	PP4108	Descriptive Analysis of Factors Influencing Walkability Among School Children in India	Neeraja Chandrasekhar, Akhilmith V, Bivina G. R., K. Krishnamurthy, Yogeshwar Navandar	NIT Calicut
4	PP3990	The Validity of the Short Driver Behaviour Questionnaire in Varying Road Users Groups in India: Age, Gender and Driving Frequency	Rahul KSHATRIYA, Pooja K M, Yogeshwar NAVANDAR, Krishnamurthy K	NIT Calicut

Session 2, Session Number 19 (15:30-17:00)

Session Chair: Thu Huyen Le

NO	PAPER ID	TITLE	AUTHOR	AFFILIATION
1	PP3899	Road Users' Willingness-To-Pay of The City Toll: Case Study of HaNoi	Duc Bao Oanh VU, Thi Thanh Binh DINH, Thanh Tu NGUYEN, Ngoc Dung BUI, Thu Huyen LE	University of Transport and Communications, Vietnam
2	PP3881	Measuring Barriers to Adoption of Sustainable Urban Freight Initiatives in Emerging Countries Using Fuzzy AHP Framework: Insights From Hanoi, Vietnam	Thi Hong Mai NGUYEN, Sy Sua TU, Hoang Mai NGUYEN, Thi Nhu NGUYEN	University of Transport and Communications, Vietnam
3	PP3905	Prioritizing Urban Transport Projects with Sustainable Development Targets: Case Study for MDCs	Phuong Thao Cao, Thu Huyen Le, Thanh Tu Nguyen	University of Transport and Communications, Vietnam

Session 1, Session Number 10 (13:30-15:00)

Session Chair: Iderlina Mateo-Babiano

NO	PAPER ID	TITLE	AUTHOR	AFFILIATION
1	PP4394	Walking in Someone Else's Shoes: Experiencing Pedestrian Intersectionality Through Design Thinking	Iderlina MATEO-BABIANO, Cherie Lynne GOMINTONG, Varsolo SUNIO, Sandy Mae GASPAY, Marie Danielle GUILLEN	University of Melbourne
2	PP4389	Intersectional Pedestrian Experiences in the Philippines: Barriers, Equity Issues, and Proposed Solutions	Sandy Mae GASPAY, Cherie Lynne GOMINTONG, Iderlina MATEO-BABIANO, Varsolo SUNIO, Marie Danielle GUILLEN	University of the Philippines - Diliman
3	PP4396	Walking Tours - a Healthy Tourism Strategy: The Case of the Philippines	Marie Danielle V. GUILLEN, Iderlina MATEO-BABIANO	University of the Philippines - Asian Institute of Tourism
4	PP4149	An Exploratory Study on Barriers to Walking among Pedestrians in Ho Chi Minh City, Vietnam: Findings from Photo-Elicitation Focus Group Discussions	Hoai Nguyen PHAM, Phuc Toan LE, Tú Anh TRINH	University of Economics Ho Chi Minh City

Session 2, Session Number 20 (15:30-17:00)

Session Chair: Hironori Kato

NO	PAPER ID	TITLE	AUTHOR	AFFILIATION
1	PP4333	High-speed Rail in Java Island: Highlights on Harmonization and Sustainability	Sutanto Soehodho	University of Indonesia
2	PP4338	High-Speed Rail Development and Industrial Innovation: Evidence from Manufacturing Sector of Japan	Ayushman Bhatt; Hironori Kato	Asian Institute of Technology, Thailand
3	PP4319	Overcoming Challenges in Thailand's High-Speed Rail Development	Chayut Ngamkhanong; Saksith Chalermpong	Chulalongkorn University, Thailand
4	PP4347	Lessons Learned from the Financial Reform of the Taiwan High Speed Rail Project	Yu-Chiun Chiou, Barbara Yen, Hseue-Hua Lin	National Yang Ming Chiao Tung University
5	PP4447	The Spillover Effects of France's 'LGV Est' High-Speed Rail Line: European Insights and Strategic Lessons for Developing Asia	Vicka Kharisma, Naoyuki Yoshino, Cynthia Solenn Pagliccia, Seetha Ram K.E.	Asian Development Bank Institute
6	PP3984	International Historical Comparative Analysis on Development Level of High-Speed Rail and Observations of Asia Countries on the Development Plans	Yoshiyuki Tajima, Shigeru Morichi, Hitoshi Ieda	Nippon Koei CO., Ltd

Session 3, Session Number 21 (11:00- 12:30)

Session Chair: Tetsuji Sato

NO	PAPER ID	TITLE	AUTHOR	AFFILIATION
1	PP3894	The Analysis of Influence Factors in Trip Rate Trend Using Predict and Provide and Decide and Provide Paradigm	Epa S.; Gari M.; Jachrizal S.; Richard B.	Universitas Indonesia
2	PP3983	Sensitivity Analysis of Machine Learning-Based Models for the Prediction of Temporal Distribution of Traffic Demand: A Case Study from Adelaide, Australia	Keyvan Pourhassan; Sekhar Somenahalli	University of South Australia - Mawson Lakes Campus
3	PP4067	MODELING TIME ALLOCATION IN COUPLE HOUSEHOLDS WITH YOUNG CHILDREN	Moeka I.; Seiji W.; Yiping L.	Shibaura Institute of Technology - Toyosu Campus; Shibaura Kogyo Daigaku
4	PP3917	Demand Estimation and Feasibility Study of Intercity eVTOL Shuttle Services for Business Use between Central Tokyo and Major Cities in the Northern Kanto Region of Japan	Tetsuji Sato; Masayoshi Yamada	Chiba Institute of Technology
5	PP4112	Exploring changes in activity-travel behavior under adverse weather conditions based on stated-preference survey	An Minh Ngoc; Wataru Yoneno; Shiomi Yasuhiro; Hiroaki Nishiuchi; Viet Hung Khuat	Ritsumeikan University; Ritsumeikan Daigaku

Session 4, Session Number 29 (13:30 - 15:00)

Session Chair: Takayoshi Futose

NO	PAPER ID	TITLE	AUTHOR	AFFILIATION
1	PP3968	Perspectives from Elderly and Persons with Reduced Mobility: Towards a More Inclusive Fare-Free Bus Service in Quezon City, Philippines	April Nadal Dela Cruz, MA; Nina RESURRECCION; Armani ALCALA; Geomilie TUMAMAO-GUITTAP; Maria Sheilah NAPALANG	University of the Philippines Diliman
2	PP4316	An Assessment of Public Transport System from the Integration Perspective: A Case Study of Pokhara Metropolitan City	Dipesh THAPA; Padma Bahadur Bahadur SHAH, Ph. D.	Nepal Engineering Council
3	PP3886	Study on Public Bus Ridership Prediction Using Machine Learning : A Case Study of Public Bus in Phnom Penh City	Piseth Srorn, M.D; Veng Kheang PHUN; Narith SAUM; Monyrath KOV	Institute of Technology of Cambodia
4	PP4039	Economic Evaluation of Bus Fares Through Willingness and Ability to Pay Approaches: A Case Study of the Trans Metro Pasundan Bus Service	Sony Sulaksono Sulaksono Wibowo, Ph.D.; Ammar ASYRAF; Siti Raudhatul FADILAH	Institut Teknologi Bandung
5	PP4217	Review on the Consolidation Process of the Local Bus Operators in Asian Megacities	Takayoshi FUTOSE	ALMEC Corporation

Session 5, Session Number 37 (15:30-17:00)

Session Chair: Syed Khairi Syed Abbas

NO	PAPER ID	TITLE	AUTHOR	AFFILIATION
1	PP3854	Evaluation of Two-dimensional Genetic Algorithm-based Centralized Traffic Signal Control versus Maxpressure-based Decentralized Control When Operating with Input Error.	Meenu Francis; Bhargab Maitra	Indian Institute of Technology Kharagpur
2	PP4296	Gamification of Traffic Signal Control: Can Non-Experts Optimize Signal Timing at an Isolated Intersection?	Daisuke H.; Yasuhiro S.; Natsutaro K.; Yoshiki S.; Yusuke T.	Ritsumeikan University College of Science and Engineering Graduate School of Science and Engineering
3	PP3884	Adaptive Signal Control for Reducing the Effects of Queues Spillback	Eamlong Tang, M.D; Sorawit Narupiti; Borith Long	Chula: Chulalongkorn University
4	PP3932	Leveraging Radar Technology for Traffic Flow Optimization: A Case Study on the Intra-Urban Expressway in Malaysia	Syed Khairi Syed Abbas; Syed Khairi SYED ABBAS; Abdulrahman Fadhil ALHALQABI; Jezan MD DIAH; Muhammad Akram ADNAN; Adi Yazid ROSLI	Universiti Teknologi MARA

Session 3, Session Number 22 (11:00- 12:30)

Session Chair: Sheikh Mokhlesur Rahman

NO	PAPER ID	TITLE	AUTHOR	AFFILIATION
1	PP4323	EVALUATING THE IMPACT OF VEHICLE EXHAUST EMISSION ON CARBON MONOXIDE (CO) AND NITROGEN DIOXIDE (NO2) LEVELS USING THE ADAPTIVE SMOOTHING METHOD (ASM) AND SATELLITE DATA	Cut Dona Kordelia, Haibo Chen, Ye liu	University of Leeds
2	PP4102	Noise Pollution in School Zones: A Traffic-Driven Analysis in Cagayan de Oro City, Philippines	Jefferson Jr. Ramos Vallente; Rakim Abdulsalam; Krisha Yvone Jonson; Garyl Luvani Bray Lamparas; Jonathan Mhar Santo; Anabel Abuzo	Xavier University Ateneo de Cagayan
3	PP4061	Time Series Changes in Transportation Infrastructure Efficiency and CO2 Emission Performance under the COVID-19 Outbreak	Lanxi KE; Kazuhiko ISHIGURO	Kobe University
4	PP4192	Assessing the Environmental Impact of Feeder Bus Services Supporting Bus Rapid Transit in Lahore: Emission Analysis and Policy Implications	Nayab Khaliq; Muhammad Nadeem; Maheen Khaliq	Saitama University; Saitama Daigaku
5	PP4327	Developing Local Vehicular Exhaust Emission Factors Using Representative Driving Cycles for Dhaka City	Sadab Ishraq Khan; Annesha Enam; Sheikh Mokhlesur Rahman	Bangladesh University of Engineering and Technology

Session 4, Session Number 30 (13:30 - 15:00)

Session Chair: Ma Sheilah Napalang_TBC

NO	PAPER ID	TITLE	AUTHOR	AFFILIATION
1	PP4267	An integrated index for measuring transit service quality based on the entropy method for objective weighting	Le HOAN; Vu Anh TUAN; Pham Vuong BAO; Nguyen Hoang MAI; An Minh Ngoc	Ritsumeikan University; Ritsumeikan Daigaku
2	PP4191	Integrating Transactional and Perceptual Data for Travel Behavior Analysis in Ride-Hailing Services (Case Study: Bandung, Indonesia)	Azwan Nazamuddin, B.Sc.; Maya Safira; Makoto Chikaraishi	Hiroshima University; Hiroshima Daigaku
3	PP3965	Performance Evaluation Scope: Comparing Route-based and Region-based Evaluation in Public Transport	Jin-Li Hu; Chia-Jung YEH; Xin WANG; Yu-Cheng TING	National Yang Ming Chiao Tung University
4	PP4115	The Role of School Travel on Student Well-being and Satisfaction in Region I, Philippines: A Structural Equation Modeling Approach	Karen Joyce Santiago, MSCE; Alexis Fillone	De la Salle University Gokongwei College of Engineering
5	PP3890	Evaluation of Safety, Comfort, and Convenience Criteria Park and Ride based on User Perceptions: A Case Study of Arif Rahman Hakim, Surabaya	Septiana Hariyani; Imma Widyawati AGUSTIN; Tiara HAFIZHA	Universitas Brawijaya

NO	PAPER ID	TITLE	AUTHOR	AFFILIATION
1	PP4143	A Comparison of Access and Egress Characteristics to and from Rail Stations in Bangkok and Metro Manila	Alexis Morales Fillone, Saksith Chalermpong, Phathinan Thaihatkul, Hironori Kato	De La Salle University
2	PP4209	Preferences of Metro Users for First Mile Public Bicycle Sharing System: A Case Study of Hanoi, Vietnam	Anh Quang Vu; Ryosuke ABE	Yokohama National University; Yokohama Kokuritsu Daigaku
3	PP4189	Two Feet or a Motorcycle Seat? The Race to Bangkok's Urban Rail	Phathinan Thaihatkul; Pichanun Tuengphun; Nur Oktaviani Widiastuti; Saksith Chalermpong; Alexis Fillone; Hironori Kato	Chulalongkorn University
4	PP4080	Analysis of Access Egress Mode Choice for Dhaka's First Mass Rapid Transit	Annesha Enam, Junaidul ISLAM, Nusrat JAHAN	Bangladesh University of Engineering and Technology
5	PP4252	The Potential of Cycling Superhighway on Promoting the Use of Cycling as Main Mode and FMLM: the Case of Jakarta	Puspita Dirgahayani; Azis Sjafruddin; Hana AMINI; Damar DEWAYANTO	Institut Teknologi Bandung

Session 3, Session Number 69 (11:00- 12:30)

Session Chair: Putu Suartawan_TBC

NO	PAPER ID	TITLE	AUTHOR	AFFILIATION
1	PP3901	Evaluation of Public Transport Service Performance Based on User Perceptions in Yogyakarta, Surabaya, and Denpasar	I Made Suraharta; Budi Mardikawati; Putu Suartawan; I Kadek Adhi Adriyana	Politeknik Transportasi Darat Bali
2	PP3916	Identifying and Evaluating the Models for Institutionalizing the Service Contracting of Public Transport Services in the Philippines	Varsolo Sunio, Ph.D.; Jacqueline Mirabueno; Garry Perez; Paul Argamosa; Enrique Ligot; George Manzano	University of Asia and the Pacific
3	PP3966	An Analysis on Optimisation Transjakarta Fare Subsidies	R Ivan Adwitiya, S.T.; Alfia Nisrina Ramadhanti; Andyka Kusuma; R Jachrizal Sumabrata; Yodya Yola Pratiwi	Universitas Indonesia
4	PP4457	Paratransit in Transition and Service Formalization Assessment Thru Network-based Analysis and Planning: The Case of Puerto Princesa City, Philippines	Erris Sanciangco; Ann Camille Fajardo; Lester Jay Ollero; Jaztin Robert Altea; Carlos Alfredo Castillo; Noriel Christopher Tiglao	SafeTravel PH Mobility Innovations Orgnaization

Session 4, Session Number 70 (13:30 - 15:00)

Session Chair: Muhamad Rizki_TBC

NO	PAPER ID	TITLE	AUTHOR	AFFILIATION
1	PP3933	Leveraging Radar Technology for Traffic Flow Optimization: A Case Study on the Intra-Urban Expressway in Malaysia	Syed Khairi Syed Abbas, MSc; Syed Khairi SYED ABBAS; Abdulrahman Fadhil ALHALQABI; Jezan MD DIAH; Muhammad Akram ADNAN; Adi Yazid ROSLI	Institut Teknologi Nasional Bandung
2	PP3962	Traffic Safety and the Aging Society: A Case Study in Japan	Sideney Schreiner, Dr. Eng.; Yoshihiko HASHINO; Atsushi FUKUDA	Nihon University; Nihon Daigaku
3	PP4055	Empirical Analysis of Queue Discharge Flow by Merging Method During Lane Closure Caused by Road Works on Inter-Urban Expressways	Mitsuaki SAKURAI; Hiroyuki ONEYAMA; Yasuhiro NONAKA	Central Nippon Highway Engineering Tokyo Co., Ltd.
4	PP4200	Exploring the Impact of Roadside Activities on Vehicle Speeds in Low-Speed Streets: A Case Study of Tainan City	cheng lian; Tzu-Chang LEE	National Cheng Kung University
5	PP4293	Analysis of Hazardous Driving Conditions on Expressways Using ETC2.0 Probe Data	Motofumi TSURU; Koji SUZUKI	Central Nippon Highway Engineering Nagoya Company Limited

Session 5, Session Number 71 (15:30- 17:00)

Session Chair: Putu Suartawan_TBC

NO	PAPER ID	TITLE	AUTHOR	AFFILIATION
1	PP3950	Driving Sustainable Change: Attitudes Toward Switching Transport Modes for Environment Benefits	FAZILATULAILI ALI, Ph.D; Dilum DISSANAYAKE; Margaret BELL; Malcolm FARROW	University of Birmingham Edgbaston campus
2	PP4069	A study on the environmental impact of the passenger wagon heating system	BayarsBayarsaikhan Bayaraa Tsend-Ayush, Ph.Daikhhan Bayaraa Tsend-Ayush, Ph.D	School of Mechanical Engineering and Transportation
3	PP4311	Trends of Circular Economy in Transport Sector of Mongolia	Chuluuntsetseg Lkhagvasuren, M.D; Amartuvshin LKHAGVASUREN	Mongolian University of Science and Technology
4	PP4472	Assessing the impact of road traffic composition on pedestrian exposure to air pollution in urban area: Evidence from Phnom Penh Streets, Cambodia	Chuluuntsetseg Lkhagvasuren, M.D; Amartuvshin LKHAGVASUREN	Institute of Technology of Cambodia

Session 3, Session Number 23 (11:00- 12:30)

Session Chair: Makoto Chikaraishi

NO	PAPER ID	TITLE	AUTHOR	AFFILIATION
1	PP4001	Assessing Water Shortages and Spatial Accessibility in Large-Scale Earthquakes: A Supply-Demand Analysis for Emergency Preparedness	Azuki Suehiro; Mustafa MUTAHARI; Nao SUGIKI; Kojiro MATSUO	Toyohashi University of Technology; Toyohashi Gijutsu Kagaku Daigaku
2	PP4081	Optimization of Conditions for Issuing Warnings Considering the Learning Process of Disaster Experience	Daiki Ueno; Teppei KATO; Kazushi SANO	Nagaoka University of Technology Department of Civil and Environmental Engineering
3	PP4325	Which factors affect the sites of potential temporary facility locations for any disasters? Findings using fuzzy AHP	Kirtesh Gadiya; Gopal PATIL; Nagendra VELAGA	Indian Institute of Technology Bombay
4	PP4114	Evaluating Transport System Accessibility Under Disasters Considering Phase-Dependent Network Functionality	Anabelle MARQUEZ; Nur SAFITRI; Makoto Chikaraishi	Hiroshima University; Hiroshima Daigaku
5	PP4002	Deployment of Foot-and-mouth Disease Quarantine Planning Model Considering the Impact of Disinfection Points on the Actual Network	Shunsuke Ono; Hiroshi Shimamoto; Hiroshi; SHIMAMOTO	Miyazaki Daigaku Kogakubu Daigakuin Kogaku Kenkyuka

Session 4, Session Number 31 (13:30 - 15:00)

Session Chair: Danny Setiawan

NO	PAPER ID	TITLE	AUTHOR	AFFILIATION
1	PP4016	Addressing Traffic Congestion: Strategic Approaches to Public Transport Optimization in Kathmandu	Anu Poudyal; Padma Bahadur Bahadur SHAHI	Nepal Engineering Council
2	PP3985	Integrated public transport index (IPTI): A new measure for identifying public transport services in Indonesia	Danny Setiawan, Sigit Priyanto, Mukhammad Rizka Fahmi Amrozi	Universitas Teknologi Yogyakarta
3	PP4128	Sketch Planning Approach and Big Data Utilisation to Improve Public Transport Services Provision in Jakarta Metropolitan Area	Hananto Prakoso; Harsis NUGRAHA	Mahidol University
4	PP4211	Evaluating Rail-Bus Integration to Enhance Public Transit Connectivity for Government Employees in Sri Lanka	K.L. Sandamali ABEY WickRAMAa; Chamila Tharangani Dathanarayana; W.M.S. Dilrukshi WEERASEKAREc	University of Colombo Faculty of Arts
5	PP4404	Methodological study for Local Public Transportation Planning and Sea Route Accessibility Assessment in Remote Island Areas	Takuto Yamaguchi; Masamitsu ONISHI; Yuka KATAOKA; Mikio TAKEBAYASHI	Kyoto University; Kyoto Daigaku

Session 5, Session Number 39 (15:30- 17:00)

Session Chair: Makoto Chikaraishi

NO	PAPER ID	TITLE	AUTHOR	AFFILIATION
1	PP4264	Investigation on the Cost-Effectiveness of Speed Bumps	Nimthera Sewwandi, MPhil; Dahami KARIYAWASAM; Ganga N SAMARASEKARA	University of Sri Jayewardenepura
2	PP4134	Study on Installation of Speed Humps as Traffic Safety Measures on Residential Roads in Bangkok	Hiroto Sakai; Atsushi Fukuda	Nihon University: Nihon Daigaku
3	PP3987	Comparative Analysis of Traffic Accidents over Two Time Periods and Approach to Road Safety Management of Highway	Moe Thet Thet Aye; Kyaing	Yangon Technological University
4	PP4202	Motorists' Response to Speed Humps: The Influence of Vehicle Type, Driving Frequency, and Acceptability on Traversal Behavior	Nimthera Sewwandi, MPhil; Ganga N SAMARASEKARA; Chaminda KONTHESINGHA; Sajith UDAYANGA	University of Sri Jayewardenepura
5	PP4332	Adapting Link and Place Framework to Transform Urban Streets into Inclusive Spaces in an Emerging Asian City: A Case Study in Jakarta, Indonesia	Yuma Tsumura; Hiroki ITO; Agustina MARTHA KIMBERLY; Hirohisa KAWAGUCHI; Hiromitsu MORI	Institute of Science Tokyo

Session 3, Session Number 24 (11:00- 12:30)

Session Chair: Tiago Novaes Mathias

NO	PAPER ID	TITLE	AUTHOR	AFFILIATION
1	PP3978	OPTIMIZATION OF DISTRIBUTION ROUTES AT PT XYZ USING THE SAVING MATRIX METHOD	Dwi Novi Wulansari, Rizqa Radhiyya Putri Permana, Juang Akbardin, Saskia Kanisaa Puspanikan	Universitas Pendidikan Indonesia
2	PP4297	Optimizing Green Logistics: Designing a Joint Distribution-Based Hub-and-Spoke Network for Sustainable Supply Chains	En Yi Chou, M.D.; En-Yi Chou; Hung-Jui Lin; Hsuan-Po Lin; I-Yun Lisa Hsieh	National Taiwan University
3	PP3866	Simulation-Based Post Operation Distribution Optimization using AnyLogic	Enkhtungalag Nyamaa; Naranbaatar Erdenesuren	Mongolian University of Science and Technology
4	PP3848	Crowd-shipping via Train Networks: Optimising Parcel Delivery by Part-timers and Commuters under Varying Occupancy Levels	Qihong HUANG, Shinya HANAOKA	Tokyo Institute of Technology School of Environment and Society
5	PP3974	Analysis of Container Handling Machinery Behavior by Synchronizing PLC and TOS data	Tiago Novaes Mathias, Ph.D.; Hideyo Inutsuka; Yoshihisa Sugimura	Port and Airport Research Institute

Session 4, Session Number 32 (13:30 - 15:00)

Session Chair: Yosuke Uchiyama

NO	PAPER ID	TITLE	AUTHOR	AFFILIATION
1	PP3875	Integration of Ride-hailing Services with Public Transportation Systems from Public Welfare and Efficiency Perspectives	Ta-Yin HU; Cheng-Fen HSUEH	National Cheng Kung University
2	PP4083	Integrating Ride-Hailing with Public Transport in Jakarta-Indonesia: Drivers Perspectives on Challenges, Efficiency, and Policy Solution	Haureta Nova Aisyah; Hitomi Sato; Toshiyuki Yamamoto	Nagoya University; Nagoya Daigaku
3	PP3862	Comparative Analysis of User Preferences and Perceptions of Different Types of Ride-Hailing Services: The Case of Hanoi, Vietnam	The Huy Tran; Shinji TANAKA; Hoang-Tung NGUYEN	Yokohama National University Institute of Urban Innovation
4	PP3858	Urban Mobility Shifts: Factors Influencing Ride-Hailing Adoption in Kathmandu Valley	Ronesh SHAHI; Padma Bahadur Bahadur SHAHI	Nepal Engineering Council
5	PP4257	Development of Business Model Canvas for On-Demand App Transport Gig Economy: Evidence from E-Hailing Platform	Yosuke Uchiyama	Chulalongkorn University

NO	PAPER ID	TITLE	AUTHOR	AFFILIATION
1	PP3919	Perspectives of Green-Collar Talents on Net-zero Carbon Emission Strategies in the Shipping Sector: A Comparative Analysis of Taiwan and Vietnam	Ren-Jun Huang; Van Dung Nguyen; Thu Hằng Hoàng; Chien-Chang Chou	National Kaohsiung University of Science and Technology - Cijin Campus
2	PP3904	Mitigating Urban Transportation Emissions through Green Open Spaces: A Quantitative Analysis in Bandung City	Christia Meidiana; Gumiwang RASPATI; Kartika SARI; Ratan GHOSH	Universitas Brawijaya
3	PP4029	Issues of Noise Pollution from Vehicles in Ulaanbaatar City and Its Reduction Management	Unursaikhan Dambadorj; Ariunbyambaa GUNCHINSUREN	School of Mechanical Engineering at MUST
4	PP4043	A Quest for Developing Sustainable Urban Mobility in Kathmandu Valley	Madan B. Regmi	United Nations
5	PP4465	Study the Dynamic Parameters of EV and CV in Urban Areas	Sharif Hossain; Anuj BUDHKAR; Prantik DAS	Indian Institute of Engineering Science and Technology

Session 3, Session Number 25 (11:00- 12:30)

Session Chair: Prakhar Aeron

NO	PAPER ID	TITLE	AUTHOR	AFFILIATION
1	PP3895	Analysis of Pavement Stress-Strain Response Under Dynamic Loading with Geogrid Reinforcement	Aanchal Tiwari; Padma Bahadur Bahadur SHAHI; Rajan Suwal; Ram Chandra Tiwari	Nepal Engineering Council
2	PP4222	Development of Roughness Prediction Models for Concrete Roads Using Machine Learning Techniques	Ranu CHOUHAN; Arnab Sur; Dhritree BAROOWA; Swati MAITRA	Indian Institute of Technology Kharagpur
3	PP4386	THE IMPACT OF OVER DIMENSION OVER LOADING (ODOL) VEHICLES ON NATIONAL ROAD DAMAGE AND ITS IMPLICATIONS FOR INFLATION IN SUMATRA FROM 2021 - 2023	Erwin Oktafianto	Universitas Lampung
4	PP4335	Identification of Road Surface Roughness for Motorized Scooters	Kazuya Tomiyama,Prakriti PANDEY, Takuma SANADA, Tomoya KITANI	Kitami Institute of Technology
5	PP4363	Assessing Superpave Criteria of Fatigue Cracking and its correlation with Physical and Chemical Parameters	Prakhar Aeron; Dharamveer SINGH	Indian Institute of Technology Bombay

Session 4, Session Number 33 (13:30 - 15:00)

Session Chair: Yuga Watanabe

NO	PAPER ID	TITLE	AUTHOR	AFFILIATION
1	PP3972	Individual Behavioral Richness in Urban Activity Patterns: Insights from Greater Jakarta's Multi-Day Travel Diary Data	Nadia QAMILLA; Azis Hakim SJAFRUDDIN; Maya Safira; Makoto Chikaraishi	Hiroshima University; Hiroshima Daigaku
2	PP4031	Travel Time to Jobs and Urban Growth in Hanoi City, Vietnam	Nguyen Ngoc Quang; Dinh Tuan Tuan Hai; Trinh Thi PHIN	Hanoi Architectural University
3	PP4220	Development of an Accessibility Analysis Framework Toward Inclusive Mobility: Focusing on Preference Inter-heterogeneity and Predictive Uncertainty	KAKERU TAKAHASHI; HIDEKI YAGINUMA; SHINTARO TERABE; MASANORI AJITO	Tokyo University of Science: Tokyo Rika Daigaku
4	PP4393	Analysis of Transportation Behavior Characteristics of Elderly People Who Require Transportation Assistance - Based on the Person Trip Survey in the Tokyo Metropolitan Area -	Shota KAWAKAMI	The Institute of Behavioral Sciences (IBS)
5	PP3967	Analysis of the Accessibility of Medical Services and the Impact on Residential Location Choice with the Introduction of Telemedicine	Yuga WATANABE, M; Sora HAYAKAWA; Yurina TSUNEYOSHI; Keiichi KITAZUME	Kansai University; Kansai Daigaku

Session 5, Session Number 41 (15:30- 17:00)

Session Chair: Daisuke Fukuda

NO	PAPER ID	TITLE	AUTHOR	AFFILIATION
1	PP4218	The Role of Electric Motorcycles in Transforming Travel Behavior and Mode Choice Preferences	Harits Rachmat Hidayat; Ilma Auraris; Muhammad Zudhy Irawan; Hironori Kato; Saksith Chalermpong; Phathinan Thaitatkul	Universitas Gadjah Mada
2	PP4330	Switching to EVs: A Study of Taxi Drivers' Decisions in Bangkok	Pichanun Tuengphun; Phathinan Thaitatkul; Arisara Chanyotha; Yosuke Uchiyama	Chulalongkorn University
3	PP3928	Analysis of Consumer Preferences on Electric Motorcycles in Taiwan	Shin-Hui Lin; Yi-Shih Chung; Chien-Chiang Tung	National Yang Ming Chiao Tung University
4	PP4012	Behavioral Intentions Related to Mode Switching to Electric Motorcycles in Bali	I Made Dwi Budiana PENINDRA; Anak Agung Istri Agung Sri KOMALADEW; I Gusti Ngurah PRIAMBADI; Dilum DISSANAYAKE	Udayana University
5	PP3947	A Comprehensive Multi-Criteria Decision-Making Framework for Assessing Electric Vehicle Adoption Among Existing and Prospective Users in India	Aishree Boruah; Digvijay Pawar; Paritosh Singh; Pritha Chatterjee	Indian Institute of Technology Hyderabad

Session 3, Session Number 26 (11:00- 12:30)

Session Chair: Rafi Haidar Roesyana

NO	PAPER ID	TITLE	AUTHOR	AFFILIATION
1	PP4079	Assessing Objective Microscale Utilitarian Walkability Based on Subjective Pedestrian Needs in Baguio City's CBD	Angelyn Ilagan; Alexis FILLONE; Maria Cecilia PARINGIT	De la Salle University
2	PP4048R1	Assessment of Walkability – Public Transport Integration: Gender Perspective	Juanita Juanita, Tito Pinandita, Sitti Hassan	UNIVERSITAS MUHAMMADIYAH PURWOKERTO
3	PP4370	Walkability Concept in Gegerkalong: An Analysis Based on Student and Pedestrian Perceptions	Rafi Haidar Roesyana; Juang AKBARDIN; Dadang M. MA'SOEM	Universitas Pendidikan Indonesia
4	PP3955	Exploring the Relationship Between Pedestrian Perceived Speed and Gap Acceptance at Midblock Crossings in Bhubaneswar City	THUNGA VISHNUVARDHAN REDDY; Partha Pratim Dey	Indian Institute of Technology Bhubaneswar
5	PP4120	Investigate Critical Factors Influencing Pedestrian Walking Speed: Speed-density Diagram Analysis	Barbara T.H. Yen; Wei-Ting SHEN	National Yang Ming Chiao Tung University

Session 4, Session Number 34 (13:30 - 15:00)

Session Chair: Tiopan Henry Manto Gultom

NO	PAPER ID	TITLE	AUTHOR	AFFILIATION
1	PP4471	The Characteristics of Natural Nano Silica and Nano Fly-ash as a Filler on Resilient Modulus Value of Hot Mix Asphalt in Indonesia	Nurhafni Karina Resentia; Bambang SUBAGIO; Eri HARIYADI; Rani PRADOTO	Bandung Institute of Technology: Institut Teknologi Bandung
2	PP4416	Effect of Aging Time on Rheological Properties of Asphalt Binders	CATHERINE MBAIKA NGAO, M.D,	National Taiwan University of Science and Technology - Gongguan Campus: National Taiwan University of Science and Technology
3	PP3980	The Characteristics of Porous Asphalt Mixtures with HDPE and CSA	Tiopan Henry Manto Gultom, Dr.; Bima Yuda TRIWIJAYA; Ery BUDIMAN; TUKIMUN TUKIMUN	Universitas Mulawarman Fakultas Teknik
4	PP3874	Comparison of Porous Asphalt Characteristics between HDPE and PET Plastics as Asphalt Substitutes	Tiopan H. M. G.; Tri B. J.; Bima Y. T.; Nita N.; Ery B.	Universitas Mulawarman Fakultas Teknik
5	PP3876	Utilization of 4% HDPE as an Asphalt Substitute in Porous Asphalt Mixtures with Variations of Coconut Shell Ash	Tiopan H. M. G.; Tri B. J.; Ryfha V. N. F.; Bagus H. A.; Johannes E. S.	Universitas Mulawarman Fakultas Teknik

Session 5, Session Number 42 (15:30- 17:00)

Session Chair: Chiaki Matsunaga

NO	PAPER ID	TITLE	AUTHOR	AFFILIATION
1	PP3902	Analysis and evaluation of the sense of security and awareness of children and their parents regarding Children's emergency houses	Chiaki Matsunaga.; Anna NAKANO; Syuji YOSHIKI; Hirofumi HORI; Seiji HASHIMOTO	Fukuoka Women's University
2	PP4182	Implementation of Road Safety Interventions for Schools in the Philippines: Experiences and Challenges	Glenn Simon Dayrit Latonero; Sahid kamid; Jose Regin Regidor	University of the Philippines Diliman
3	PP4451	Caution! Children Crossing! Examining the Perception of Child Pedestrians on Safety on the Road in Quezon City, Philippines	Nina An Kayla Dumo Resurreccion, BA	University of the Philippines Diliman School of Urban and Regional Planning
4	PP4250	Star Rating Methodology for School Traffic Safety in Vietnam	Xuan-Quy LE, Ph.D; Tien Dung CHU; Huy Nghia NGUYEN	University of Transport and Communications
5	PP4288	Assessing the Impact of a Gamified E-Learning Platform on Road Safety Knowledge Among Philippine Youth	Sahid Kamid; Glenn Simon LATONERO; Sandy Mae GASPAY; Ma. Sheilah G. NAPALANGD	University of the Philippines - National Center for Transportation Studies

Session 3, Session Number 27 (11:00- 12:30)

Session Chair: Hidenobu Matsumotoana

NO	PAPER ID	TITLE	AUTHOR	AFFILIATION
1	PP4139	Land Suitability Assessment for Industrial Development Using GIS: A Case Study of Rohtak and Jhajjar, Haryana	Chetna Rathee	NICMAR University, Pune
2	PP3949	Redefining Urban Centers in Bandung Through the 15-Minute City Principles: A Spatial Suitability Analysis	Maya Safira; Erlangga Abyantara	Bandung Institute of Technology: Institut Teknologi Bandung
3	PP3956	Spatial Concentration and Dispersion of Foreign Travelers by Nationality at Prefectural Level in Japan	Hidenobu Matsumoto; Koji Domae	Kansei Gakuin Daigaku - Kobe Sanda Campus
4	PP4253	New Workspaces in the Digital Era, The Spatial Analysis of Potential Locations in Bandung City	Maya Safira; Naufal Muhammad Khalishan	Bandung Institute of Technology: Institut Teknologi Bandung
5	PP4230	Impact of Transportation Accessibility in The Compact-Plus-Network City on Residential Population Distribution	Kei Fukuyama, Tomoo Aoki	Tottori University

Session 4, Session Number 35 (13:30 - 15:00)

Session Chair: G.D. Ransinchung

NO	PAPER ID	TITLE	AUTHOR	AFFILIATION
1	PP4024	Study on the Aerodynamic Characteristics of Unmanned Aerial Vehicles	Amarmend Galsandorj; Uyanga SUKHBAATAR; Daariimaa ENKHTUYA; Nomungerei ERDENEBAT	Mongolian University of Science and Technology
2	PP4259	Extraction of Abnormal Rust Regions of Weathering Steel Using Semantic Segmentation	Shuta Notsu; Makoto OHYA; Makoto FUJUI	Mongolian University of Science and Technology
3	PP4466	Energy Development for Transportation: A Constructive Literature Review	Jin-Li Hu, Yang Li, Jung-Chi Chew	National Yang Ming Chiao Tung University
4	PP4459	Analysis of Vehicle Dynamic Parameters on Two Lane and Four Lane Roads	Anuj Kishor Budhkar; Sharif Hossain; Deepa Thangjam	Indian Institute of Engineering Science and Technology
5	PP4350	Performance of Geopolymer Concrete Using Recycled Aggregates-A Sustainable Paving Solution	Ayana Ghosh; G.D. Ransinchung; Praveen Kumar; Devendra Kumar	Indian Institute of Technology Roorkee

Session 5, Session Number 43 (15:30- 17:00)

Session Chair: Harshit Anmol Saini

NO	PAPER ID	TITLE	AUTHOR	AFFILIATION
1	PP4279	Analysis of Road Attribute Risk Factor in Pangkalpinang, Indonesia	Desy YOFIANTI, Anindia AYUNINGTIAS	Universitas Bangka Belitung
2	PP4260	Safety at Minor Intersections along Highways with Roadside Developments: A Case Study in Indian Context	Swati Maitra; Shibin K V SHAHID	Indian Institute of Technology Kharagpur
3	PP4034	Risk Assessment of Merging Maneuvers at Narrow Bridges: Insights from Random Effect Logistic Regression	Harshit Anmol Saini, MTech; Nipjyoti Bharadwaj	Indian Institute of Technology Guwahati
4	PP4172	Development of a model for risk of occurrence of stuck on winter highways	Keito Kataoka; Kazushi SANO; Teppei KATO; Tetsuro HARAYAMA	Nagaoka University of Technology Department of Civil and Environmental Engineering
5	PP3856	Prediction of Expressway Accident Locations Using Contribution Information from Grad-CAM	Takahiro Tsubota, Shinichiro Yabata, Toshio Yoshii, Jian Xing	Ehime University

Session 3, Session Number 28 (11:00- 12:30)

Session Chair: Gen Hayauchi

NO	PAPER ID	TITLE	AUTHOR	AFFILIATION
1	PP4213	Behavioural Factors Contributing to Offences Committed by Bus Crews in Sri Lanka's Private Bus Transport Sector	Chamila Tharangani Danthanarayana; K.L. Sandamali ABEYWICKRAMA; H.M.N. Anuththara HERATH	University of Colombo Faculty of Arts
2	PP4013	Comparative Analysis of ARIMA, LSTM, and Transformer Based Model for Bus Travel Time Prediction Under Heterogeneous Traffic Conditions	Hasanka Prasad Wijesundara; Vasantha WICKRAMASINGHE; Damayanthi HERATH; Sara MORIDPOUR	University of Peradeniya
3	PP3873	Curbside Bus Stops and their impact on urban traffic flow: A case study on Pokhara, Nepal	Hemant Tiwari; Suraj Bahadur Thapa; Asmita Pokhrel	Traffic and Transport Unlimited Solutions
4	PP4352	User Perceptions on Travel Behavior and Bus Service Performance during COVID-19 in East Java, Indonesia	Putu Cinthya Pratiwi Kardita; Achmad Wicaksono; Muhammad Ruslin Anwar	Universitas Udayana
5	PP4320	An Assessment of Intercity Public Bus Services: A Case Study of the Kathmandu-Dhulikhel Route	Ujjwol THAPA , Padma Bahadur SHAHI	Kathmandu University

Session 4, Session Number 36 (13:30 - 15:00)

Session Chair: Ali Anjomshoe

NO	PAPER ID	TITLE	AUTHOR	AFFILIATION
1	PP3927	Shared Storage Impact on Rice Supply Chain Network	Andrean Maulana; Ade Sjafruddin; Russ Bona Frazila; Febri Zukhruf	Institut Teknologi Nasional Bandung
2	PP3842	Delay Management in Pharmaceutical Cold Chain Logistics: A Systematic Literature Review	ALI ANJOMSHOAE; Alain JACQUET; Arnaud DRAGICEVIC; Arisara CHANYOTHA; Waleed ALAHMAD	Chulalongkorn University
3	PP3846	Anxiety amid the Rise of Automation in the Logistics Industry: A Preliminary Study in Singapore	Cheng-Hsien Hsieh; Wan Chin Crystal Poh; Yen-Heng Chen; Chi-Chang Lin; Yu-Kai Huang	Singapore University of Social Sciences
4	PP3850	Mandalay-Yangon Freight Transport Analysis	Sai Aung Hla Min Naing, ME; Sai Aung Hla Min Naing; Kyaingb	Yangon Technological University
5	PP4373	Synchromodality to Increase Reliability of Freight Transportation in Indonesia: Challenges and Opportunities	Sekar Sakti; Russell G. Thompson	Gadjah Mada University; Universitas Gadjah Mada

Session 5, Session Number 44 (15:30- 17:00)

Session Chair: Thanh Tu Nguyen

NO	PAPER ID	TITLE	AUTHOR	AFFILIATION
1	PP4032	Analysis of the Spillover Effects of Public Relations under Large-Scale Highway Construction Regulations Using Statistical Causal Discovery	Kodai Okumura, Hideki YAGINUMA, Kazunori TATEMATSU, Shintaro TERABE, Masanori AJITO, XUEQING Bo	Faculty of science and Technology, Tokyo University of Science
2	PP4324	A Review of Tourism Travel Demand Management (TTDM) to Relieve Resident-Tourist Conflicts: Kyoto City Case Study	Siok Zhen Oi; Masamitsu Onishi; Jan-Dirk Schmcker; Satoshi Nakao	Kyoto University Faculty of Engineering Graduate School of Engineerin
3	PP4177	Rearrangement of Commuting Allowance Policy among Government Officials to Promote Public Transport Use: The Case of Vientiane, Lao PDR	Suphany HEUANGKE; Fumihiko NAKAMURA; Shinji TANAKA; Maria GARCIA	Ministry of Public Works and Transport
4	PP4020	Potential mode choice and traffic improvement in Jakarta Golden Triangle CBD and its road network vicinity due to area-based congestion pricing implementation	Sutanto Soehodho; Novra Anumasta, M.Sc.; Nahry Nahry	Universitas Indonesia
5	PP3882	Response mechanisms for incentives on a smartphone application to spur visits to city centers	Gen HAYAUCHI; Suzuka Iwamoto; Ryo Kanamori; Takayuki Morikawa	Nagoya University

Session 6, Session Number 45 (09:00-10:30)

Session Chair: Masria Mustafa

NO	PAPER ID	TITLE	AUTHOR	AFFILIATION
1	PP3907	Attention-Based Spatial-Temporal Graph Network for Urban Traffic Volume Estimation	Anh Phuong NGUYEN; Tzu-Chang Lee	National Cheng Kung University
2	PP4073	Assessing the Impact of Flexi-Time Schedules on Morning Peak-Hour Congestion: A Cox Proportional Hazard (CPH) Approach	Hamza Zubair; Susilawati Susilawati; Amin Talei; Ziyuan Pu	Monash University Malaysia
3	PP4225	Evaluation of Traffic Performance and Signal Coordination at Urban Intersections: A Case Study of Pokhara City	Thusitha Chandani Chandani Shahi; Kushal Bhusal	Nepal Engineering College
4	PP4098	Evaluating the Impact of Dedicated Bicycle Lane on Urban Traffic Dynamics	Masria Mustafa; Ainul K MOHD NOR; Sorawit NARUPITI	Universiti Teknologi MARA
5	PP4290	Mainstreaming Traffic Impact Assessment in Urban Centers: A Capacity Evaluation of Local Implementing Institutions in the Philippines	Sheila Flor Javier; Jerome Ballarta	University of the Philippines Diliman

Session 7, Session Number 53 (11:00-12:30)

Session Chair: Adrian Firdaus

NO	PAPER ID	TITLE	AUTHOR	AFFILIATION
1	PP4027	Analyzing the implementation of Public Private Partnership on a trans-shipment port within a non-commercial port network	Adrian Firdaus; Ade Sjafruddin; R uss Bona Frazila; Febri Zulkhruf	Institut Teknologi Bandung
2	PP4036	The Efficiency Measurement of Major Ports in East Asia: A Data Envelopment Analysis on a Competitive Market	Chen YEN; Kazuhiko ISHIGURO; Mikio TAKEBAYASHI	Kobe University
3	PP4445 (PP4449)	Improving the Efficiency of Land-Sea Connection at Container Port Terminals	Hironori Kato; Hideyuki Tsujimoto; Kazuhisa Fukasaku; Takao Omori; Tomomi Tsuchiya; Gota Otaka	JTTRI
4	PP3938	Development of Safety Monitoring System at Container Terminal Gate	Tiago Novaes Mathias, Ph.D.; Putu Widhi Aprilia; Takeshi Shinoda	Port and Airport Research Institute
5	PP4486	Digital Port Integration and Terminal Efficiency: Evidence from Vessel, Truck, and Container Turnaround Times in Japanese Container Terminals	Ryuichi Shibasaki; Daigo Shiraiishi; Wenru Zhang; Yesim ELHAN-KAYALAR	University of Tokyo

Session 8, Session Number 61 (13:30-15:00)

Session Chair: Tetsuo Yai

NO	PAPER ID	TITLE	AUTHOR	AFFILIATION
1	PP4305	Walkability and Urban Mobility in Ulaanbaatar: Analyzing Pedestrian Infrastructure and Challenges	Chuluuntsetseg Lkhagvasuren, M.D; Amartuvshin LKHAGVASUREN	Mongolian University of Science and Technology
2	PP4477	Study of the development of pedestrian routes with equity and justice principles (Case Study: Revitalization of the Sudirman Pedestrian Route, Jakarta)	Malindo Andhi Saputra Marpaung; Lilik Andriyani; Sondang Napitupulu; Isti Anisya; Muhammad Firdaus; Andika Dwipayana	Airmas Engineering Consultant
3	PP4005	Mainstreaming Traffic Impact Assessment in Urban Centers: A Capacity Evaluation of Local Implementing Institutions in the Philippines	Venny Veronica NATALIA, Doctoral; Muhammad IRFAN; Khilda Wildana NUR; Yashinta Kumala Dewi SUTOPO; Marly Valenti PATANDIANAN; Zean Amadeus MUSU	University of the Philippines Diliman
4	PP4339	Technical and policy implications for street space sharing based on new envelope principles	Tetsuo Yai; Lubing Zou	Japan Transport and Tourism Research Institute

Session 9, Session Number 72 (15:30-17:00)

Session Chair: Toru Hagiwara

NO	PAPER ID	TITLE	AUTHOR	AFFILIATION
1	PP3954	Accuracy in Estimation of Vehicular Speed and Stopping Distance by the Pedestrians Under Mixed Traffic Conditions	THUNGA VISHNUVARDHAN REDDY; Partha Pratim Dey	Indian Institute of Technology Bhubaneswar
2	PP4025	Characteristics and Stability of Car-following Models in Autonomous Vehicles under Mixed Traffic Environments	Ta-Yin HU; Cheng-Fen HSUEH	National Cheng Kung University
3	PP4076	Development of Time-space Diagram showing Changes in Visibility Information along the Route in Winter	Toru Hagiwara, Ph.D; Yasuhiro Nagata; Sho Takahashi; Masahiro Yagi	Hokkaido University
4	PP4310	Big Data Analytics to Improve Origin-Destination Matrix Estimation for Traffic Planning	Syed Khairi SYED ABBAS, MSc; Syed Khairi SYED ABBAS; Kar Keong CHIN; Jia Jiun GAN; En Tong SOO	Universiti Teknologi MARA
5	PP4348	Traffic Conflict Analysis in Multi-Lane Roundabouts: A VISSIM and Genetic Algorithm Approach	Deepanshu Soni, M.tech; Abhijnan Maji; Indrajit Ghosh	Indian Institute of Technology Roorkee

DAY 3

Wednesday, September 3rd 2025
UNS Tower 2nd Floor, Vocation Class 2

Session 6, Session Number 46 (09:00-10:30)

Session Chair: Afsana Haque

NO	PAPER ID	TITLE	AUTHOR	AFFILIATION
1	PP3988	Bridging the Gap: A Policy Evaluation of Transit-Oriented Development in Dhaka	AFSANA HAQUE, PhD (commencing)	Jahangirnagar University
2	PP4084	An initial discussion about a business collaborative mobility model	Andre Dantas, Ph.D; Andre DANTAS; Sidenev SCHREINER; Atsushi FUKUDA	transporteINTEL
3	PP4089	The Integrated Inland Waterway Transit-Oriented Development (TOD) Suitability Index: A Planning Framework Optimizing Inland Waterways as Transportation Corridors	Angelo Paulo Abella Mogul, MTLA; Daryl Rone CARIS' O; Janella Sophia MANAHAN; Ailiana Vira De Guzman	Bulacan State University
4	PP4183	Using Grounded Theory to Explore the Role of Motorcycles in Urban Transportation Policies and Regulations	Guan-Yau HUANG; Tzu-Chang LEE	National Cheng Kung University
5	PP4409	International Benchmarking of Transit-Oriented Development: Implementation Processes, Regulatory Frameworks, Institutional Setup, Stakeholder Roles, and Land Value Capture Mechanisms	Anh Tuan Vu, Ph.D.; Ngoc An NGUYEN; Hoang Tung NGUYEN	Vietnamese-German University

Session 7, Session Number 54 (11:00-12:30)

Session Chair: Uyanga Sukhbaatar

NO	PAPER ID	TITLE	AUTHOR	AFFILIATION
1	PP4227	Developing an Excel-Based Route Planning System for Agricultural Products Pickup and Delivery in Benguet, Philippines	Alerik Ezekiel Ruiz, BSCE; Kristen Ian Daniel Roquel; Alexis Fillone; Marla Maniquiz-Redillas	De la Salle University
2	PP4006	Freight Transport Demand Modeling for an Integrated Transport and Logistics Network Aligned with Mongolia's Regional Development Strategies	Ariunbayar Samdantsoodol, Ph.D; Naranbaatar Erdenesuren	Mongolian University of Science and Technology
3	PP4197	Machine Learning-Based Prediction of Heavy Truck Tire and Brake Drum Temperatures from Vehicle Parameters	Hsin-Ting Hsiung; Hsin-Wei Chang; Chen-Hao Peng; Hugh Woo, Ph.D.	National Yang Ming Chiao Tung University College of Management
4	PP4023	APPLICATION OF SWARA AND TOPSIS METHOD FOR LOCATION SELECTION OF LOGISTICS CENTER IN ULAANBAATAR	Uyanga Sukhbaatar, Ph.D.; Daariimaa ENKHTUYA; Amarmend GALSANDORJ	Mongolian University of Science and Technology

DAY 3

Wednesday, September 3rd 2025
UNS Tower 2nd Floor, Vocation Class 2

Session 8, Session Number 62 (13:30-15:00)

Session Chair: Naohiko Hibino

NO	PAPER ID	TITLE	AUTHOR	AFFILIATION
1	PP4180	Evaluating the Impact of Metro Manila Cycling Infrastructure on the Transport Modal Usage of Work Commuters	Fe Isabel ADARNE, Crispin Emmanuel DIAZ	URVANO Planners and Builders
2	PP3885	Continuation and Return of Passenger Behavior Post-COVID-19 Using Long-Term Automatic Ticket Gate IC Card Data with Focus on Trip Frequency, Commuter Pass Ownership, and Changes in Departure Time	Naohiko Hibino, Ph.D.; Shinya YAMADA; Wataru YAKITA	GRIPS
3	PP4170	Investigation of traffic information on route choice models considering drivers' personal characteristics	Taufik Sugian Sumardi, M.Sc; Hiroyuki Oneyama; Masami Yanagihara	Tokyo Metropolitan University Faculty and Graduate School of Urban Environmental Sciences
4	PP3863	Effect of Improvement Bus Quality on Mode Choice Behavior in Dili, Timor-Leste	Hitomi Sato; Feliciano Ximenes; Meilan Jiang; Takayuki Morikawa	Anti-Corruption Commission
5	PP4281	Forecasting Traffic Demand Under Toll Pricing Scenarios in Vietnam: A Simulation-Based Approach	Thu Huyen LE; Anh Tuan VU; Thi Thanh Huong NGUYEN*	University of Transport and Communications

Session 9, Session Number 73 (15:30-17:00)

Session Chair: Veng Kheang Phun

NO	PAPER ID	TITLE	AUTHOR	AFFILIATION
1	PP3982	Weighting Approach for Assessing Walkability Index of Urban Streets: Case Study of Phnom Penh, Cambodia	PLACK So Khit, M.D; Veng Kheang PHUN	Institute of Technology of Cambodia
2	PP4309	Pedestrian Oasis: Redefining Urban Spaces for Sustainability and Community Engagement in Songdo, South Korea	Iksoo Jo, B.S.; Jisoo Ooh; Hyein Kim; Taeyun Lim	University of Utah
3	PP4405	Walkability and Urban Mobility in Ulaanbaatar: Analyzing Pedestrian Infrastructure and Challenges	Chuluuntsetseg Lkhagvasuren, M.D; Amartuvshin LKHAGVASUREN	Mongolian University of Science and Technology

Session 6, Session Number 47 (09:00-10:30)

Session Chair: Ryuichi Shibasaki

NO	PAPER ID	TITLE	AUTHOR	AFFILIATION
1	PP3851	Analysis of the Effects of Urban Area Expansion due to Railway Development in Asian Megacities Using Optical Satellite Data	Hiroki MORI; Ivan GORYUNOV; Takumi NARUSAWA; Makoto Ito; Hajime INAMURA; Shigeru MORICHI	Japan Transport and Tourism Research Institute
2	PP4166	The Effects of Expressway Opening Timing on Residents Settlement Intentions	Takui Narayama; Kunihiro KISHI; Jun MATSUZAKI; Shin-ei TAKANO	Hokkaido University; Hokkaido Daigaku
3	PP4164	Assessment of Station Areas of MRT Line 6 in Dhaka Using Place-making Concept	AFSANA HAQUE, PhD; TASNUMA TASNUMA	Jahangirnagar University
4	PP3937	Understanding Transfer Intentions and Areas Suitable for Introducing Transfer-based DRT- Case study on Toyoake City in Japan	Tatsuki Nakanishi; Yukimasa Matsumoto	Meijo University
5	PP3944	Estimation of Regional GDP in Cambodia Using Nighttime Light Data	Honomi KASHIHARA; Ichio MOTONO; Tsuyoshi OTAKE	University of Tokyo

Session 7, Session Number 55 (11:00-12:30)

Session Chair: Kapil Kumar Meena

NO	PAPER ID	TITLE	AUTHOR	AFFILIATION
1	PP3879	Assessing the air pollution exposure to school children in different modes of transport while commuting to school: A Case of Kharagpur, India	Kapil Kumar Meena, Anusha Sumbhate, Arkopal Goswami	Indian Institute of Technology Kharagpur
2	PP3891	Factors Affecting Air Quality at Urban Parking Area: Case Study of Motorcycle Emissions Inside Institute of Technology of Cambodia (ITC)	Lihong Phiny, M.D	Institute of Technology of Cambodia
3	PP4395	Every breath you take: Measuring traffic-related air pollution (TRAP) exposure at intersections under elevated structures in Metro Manila	Norbert Anthony Gerome Cuaresma Paranga, Msc; Sandy Mae Gaspay; Roseanne Ramos	University of Santo Tomas
4	PP4187	Assessing the impact of road traffic composition on pedestrian exposure to air pollution in urban area: Evidence from Phnom Penh Streets, Cambodia	PLACK So Khit, M.D; Veng Kheang PHUN	Institute of Technology of Cambodia

Session 8, Session Number 63 (13:30-15:00)

Session Chair: Russell George Thompson

NO	PAPER ID	TITLE	AUTHOR	AFFILIATION
1	PP3945	Performance Evaluation of Global Container Shipping Companies: Combining quantitative and qualitative approaches	Po-Hsing Tseng, Ph.D.; Nick Pilcher	National Taiwan Ocean University
2	PP3885	Enhancing the performance of global logistics networks using the Physical Internet	Russell Thompson; Ryuichi Shibasaki; M. Pournader; Geoff Featherstone; Wenru Zhang; Zhanhong Wu	University of Melbourne Graduate School of Business and Economics; The University of Melbourne Melbourne Business School
3	PP4244	Evaluating Corporate Image Through Multimedia Advertising: An IPA Study of Parcel Delivery Services	Thi Thu Thao Bach; Ting-Kuan Ting; Taih-Cherng Lirn	National Taiwan Ocean University
4	PP4226	Impact of Proposed Truck Routes in Vehicular Movement in Metro Manila	Riches Bacero; Alexis FILLONE	De la Salle University

Session 9, Session Number 75 (15:30-17:00)

Session Chair: Jefferson Jr. Ramos Vallente

NO	PAPER ID	TITLE	AUTHOR	AFFILIATION
1	PP4106	Developing Optimal Pedestrian Evacuation Networks for Seismic Events: A Spatial Analysis and AHP Approach in Uptown Cagayan de Oro City	Jefferson Jr. Ramos Vallente, B.Sc.; Jhonhel SONTOSIDAD; Anna Patricia EDMA; Angela Jolie GALARRITA; Karl Francis HONCULADA; Anabel ABUZO	Xavier University Ateneo de Cagayan Cagayan de Oro, Misamis Oriental PHILIPPINES
2	PP4142	Assessing the Cascading Impact of Tunnel Failures on Network Resilience	Wei Tien Chang; Wen-Yuan Wu; Yu-Ting Hsu	National Taiwan University
3	PP4271	Assessment of Heat Intensification in Relation to Climate Variability in Kozhikode District, Kerala, India	Resmi S R, Ph.D.; Nishant Pawar; Vishal Verma; Tejpal Kumawat; Sandeep Sandeep	National Institute of Technology Calicut
4	PP4439	Route Simulation of Bridge and Road Infrastructure Under Diverse Flood Scenarios: A Case Study of Cagayan de Oro City, Philippines	Alexis Morales M Fillone, PhD; Anabel ABUZO; Alexis FILLONE; Jefferson VALLENTE; Gifrey SULAY; John OSIA	La Salle University
5	PP4100	Factors Influencing the Evacuation Behavior of Foreign Residents in Japan: A Case Study of the 2024 Noto Earthquake	Sunkyung Choi; Wenzhuo MA; Shinya HANAOKA	Tokyo Institute of Technology School of Environment and Society; Tokyo Kogyo Daigaku Kankyo Shakai Rikogakuin

Session 6, Session Number 48 (09:00-10:30)

Session Chair: Rajat Rastogi

NO	PAPER ID	TITLE	AUTHOR	AFFILIATION
1	PP3992	Policy Analysis on Tourism Development in the Inner Mongolia	Amartuvshin Lkhagvasuren, PhD; Dorjnyam Erdeneuul	Mongolian University of Science and Technology
2	PP4091	Impact of Transportation Network Linkages on Foreign Tourist Consumption	Ming Zhang, Ph.D; Takaaki Okuda	Nanzan University; Nanzan Daigaku
3	PP4185	Water Governance in Traditional Knowledge for Transportation and Ecotourism Sectors around Jayapura Papua	MONITA Yessy Beatrick WAMBRAUW, Ph.D; Dr. Elisabeth Veronika WAMBRAUW; Dr. Irja Tobawan SIMBIAK	Cenderawasih University; Universitas Cenderawasih
4	PP4413	Tourists' Intra-destination Visitation Choices: Influence of Proximity, Socio-Demographics, and Activity Preferences	Suvam Banerjee, M.Tech.; Rajat Rastogi; Indrajit Ghosh	Indian Institute of Technology Roorkee
5	PP4245	Local Transport and Tourism Promotion in Remote Island Regions	Yuka Kataoka, Ph.D; Mikio TAKEBAYASHI; Hiromichi YAMAGUCHI	Ehime University

Session 7, Session Number 56 (11:00-12:30)

Session Chair: Rusdi Rusli

NO	PAPER ID	TITLE	AUTHOR	AFFILIATION
1	PP4241	Empowering Youth for Safer Roads: A Scenario-Based Approach to Road Safety Education in San Fernando, Pampanga, Philippines	Daryl Ignacio; Princess Ann Tayag; Raymart Canlas; Michael Maglalang; Michelle Ong; Glenn Simon Dayrit Latonero	University of the Philippines Diliman
2	PP3948	Understanding Bicycle Lane Misuse: Key Factors and Road Safety Concerns	Puteri Intan Solha SALIM; Rusdi RUSLI, Ph.D	Universiti Teknologi MARA
3	PP3897	Heavy Goods Vehicle Drivers' Insights on Crash Contributing Factors in Rigid and Articulated Lorries	Nurul Atiqah ALI; Rusdi Rusli, Ph.D; Puteri Intan Solha SALIM; Mohd Azizul LADIN	Universiti Teknologi MARA
4	PP4129	Risk Prediction of Vehicle Collision Involved with Motorbikes: An Application of A Combined Neural Network of CNN and LSTM	Ta-Yin Hu; Li-Wen CHEN; Chen-Yang HSIEH; Cheng-Fen HSUEH	Chaoyang University of Technology

Session 8, Session Number 64 (13:30-15:00)

Session Chair: Prawira Fajarindra Belgiawan

NO	PAPER ID	TITLE	AUTHOR	AFFILIATION
1	PP4278	Beyond Numbers: Understanding What Shapes Transport Mode Choices among Students at the University of the Philippines Diliman	Geomilie Sardan Tumamao-Guittap; Armani Alcala; Nina An Kayla Resurreccion; April DELA CRUZ; Sheilah NAPALANG	University of the Philippines Diliman
2	PP4095	Private Motorized Vehicle Dependence: Exploring Access and Egress Mode Patterns of Commuter Line Passenger in Yogyakarta Urban Area	Damar Pratita Pratita Dewayanto; Kayissa Fitri	Bandung Institute of Technology School of Architecture Planning and Policy Development
3	PP4041	Investigating the role of emotional well-being during the mobility restriction policy into people's intention to travel after the policy is lifted: Learning from the COVID-19 outbreak in Indonesia	Muhamad Rizki; Muhammad Zudhy IRAWAN; Prawira BELGIAWAN; Tri Basuki JOEWONO; Dwi PRASETYANTO	Institut Teknologi Nasional Bandung
4	PP4078	Comparison of Household Escorting Responsibilities Across Regions	Yurie Toyama; Ryo Ariyoshi; Gen Hayauchi	Nagoya University

Session 9, Session Number 72 (15:30-17:00)

Session Chair: Agnivesh Pani

NO	PAPER ID	TITLE	AUTHOR	AFFILIATION
1	PP4109	Qualitative assessment of traffic congestion issues in car-oriented cities: Insights from Malaysian commuters	Hamza Zubair; Susilawati SUSILAWATI; Amin TALEI; Ziyuan PU	Monash University Malaysia
2	PP4207	Evaluation of the Impact of Land Use on On-Street Parking Demand: A Case Study of Ximen Road, Tainan City	Yao-Wen HSU; Tzu-Chang LEE	National Cheng Kung University
3	PP4361	Trip Pattern and Identification of Food Freight Generation in Kramat Jati Wholesale Market Jakarta	Adil Afrizal Gani; R Ivan Adwitiya; Alifia Nisrina Ramadhanti; Andyka Kusuma; Ellen Sophie Wulan	Universitas Indonesia
4	PP4414	Analysing the Economic Geography of Urban Restaurants and Mapping On-Demand Food Deliveries in the Last Mile	Suprava Mishra; Agnivesh Pani; Ankit Gupta	Indian Institute of Technology BHU Varanasi
5	PP4418	Nationwide Freight Traffic Demand Prediction using Toll Plaza Data: A Case Study of PROPHET-SARIMA Modelling for Indian Highways	Suprava Mishra; Agnivesh Pani; Simon Oh	Indian Institute of Technology Roorkee

Session 6, Session Number 49 (09:00-10:30)

Session Chair: Sylvia He

NO	PAPER ID	TITLE	AUTHOR	AFFILIATION
1	PP4161	Traffic Sensing Using Data-Driven Surveillance Cameras: A Survey of Methodologies, Technological Advances, and Deployment Challenges.	Aulia Rahman; Daisuke Fukuda	University of Tokyo Graduate School of Engineering Faculty of Engineering; Tokyo Daigaku Daigakuin Kogakukei Kenkyuka Kogakubu
2	PP3996	Unveiling Axle and Wheel Configurations: A Deep Learning Approach for Vehicle Identification	Langgeng Asmoro, Langgeng ASMORO, Maman BUDIMAN, Mitra DJAMAL	Politeknik Keselamatan Transportasi Jalan
3	PP4273	Analysis of the Topological Similarity of Street Networks in Cities Around the World Using Graph2vec	Atsushi Sugama	Saitama University
4	PP4322	Data for Travel Behaviour Research: Recent Advances, Challenges and Opportunities in The Era of Smart Cities	Sylvia Y. He, Ph.D.; Sui Tao; Zhenzhen Wang; Shuli Luo	The Chinese University of Hong Kong

Session 7, Session Number 57 (11:00-12:30)

Session Chair: Daariimaa Enkhtuya

NO	PAPER ID	TITLE	AUTHOR	AFFILIATION
1	PP4402	Navigating diversions: analyzing alternate airport selection and recovery decisions in commercial aviation	Bolong Zhou; Kashin Sugishita; Shinya Hanaoka; Enoch Lee; Hai Yang	The Hong Kong University of Science and Technology
2	PP4481	Analysis of Factors Affecting Competition of Low-Cost Carriers	Daariimaa Enkhtuya; Uyanga Sukhbaatar; Amarmend GALSANDORJ	Mongolian University of Science and Technology
3	PP4181	Beyond a Transfer Hub: Leveraging International Airports for Startup Growth and Innovation	Pornnapas Khemthong; Yoshitsugu Hayashi; Pawinee lamtrakul ;Marla Maniquiz-Redillas; Tsuyoshi Takano; Hiroyuki Morita	Chubu University

Session 8, Session Number 65 (13:30-15:00)

Session Chair: Sandy Mae Gaspay

NO	PAPER ID	TITLE	AUTHOR	AFFILIATION
1	PP4199	Analysis of Jakarta MRT's Operational Performance Using Passenger Tapping Data on the Lebak Bulus-Bundaran HI Route	Airizya Nurmariam RIZADH; R. Jachrizal SUMABRATA; Hananto Prakoso	Mahidol University
2	PP4234	Comparative Analysis of Sustainability Performance and Customer Loyalty in Taiwan's Light Rail Transit Systems	Jung Yeh; Yuh-Ren YEN; Chia-Hui LEE; Hsiang-Chuan CHANG	Tamkang University College of Business and Management
3	PP4162	Bridging the Gap: Understanding the Needs of Passengers with Reduced Mobility in Using Railway Transport	Sandy Mae Gaspay, Ph.D.; Maria Sheilah Napalang	UP Diliman: University of the Philippines Diliman
4	PP4372	An excellent achievement of Japanese urban rail development: Case study of "Eastern Kanagawa Line" project	Atsufumi Kameyama; Kenji SHIMIZU; Hitoshi ASAMI	Japan Railway Transport and Technology Agency
5	PP4398	Factors Contributing to Non-bulk Rail Freight Demand for Improving Modal Share and Economic Growth	Chamila Tharangani Danthanarayana; Geoffrey T. Clifton; John D. Nelson	University of Colombo

Session 9, Session Number 72 (15:30-17:00)

Session Chair: Chen Yu Lin

NO	PAPER ID	TITLE	AUTHOR	AFFILIATION
1	PP4119	Travel behavior simulation based bike-sharing station distribution	Yusfita Chrisnawati; Yusak Susilo	BOKU University, Vienna, Austria
2	PP4179	Cyclist behavior analysis on the perception of self and others: a structural equation modeling approach	Yu-Ting Hsu; Che An Lin	National Taiwan University
3	PP4371	Determination of Minimum One-Way Bicycle Lane Width Considering Cyclists' Maneuvers	Iñigo Wynnet Alvarez; Ryan Ramde Maguddayao; Sandy Mae Gaspay	University of the Philippines Diliman
4	PP4448	Comparative Analysis of Specifications on Swappable Light Means of Transport (LMT) Batteries in Asia	Shin-Hui Lin; Yu-Wei Lee; Yi-Hsuan Li	National Yang Ming Chiao Tung University
5	PP4484	A Research on The Redistribution Strategy of Bicycle Sharing System Through Historical Usage Pattern Analysis	Nayli Nazurah Binti Norhalim; Kazushi SANO; Kalpana LDCHN; Frank PERERA	Nagaoka University of Technology

Session 6, Session Number 50 (09:00-10:30)

Session Chair: Ching-Jung Ting

NO	PAPER ID	TITLE	AUTHOR	AFFILIATION
1	PP4140	A Hybrid Tabu Search and Variable Neighborhood Descent Heuristic for the Load-dependent Vehicle Routing Problem with Time Windows	Ching-Jung TING; Yu-Siang HONG	Yuan Ze University
2	PP4441	A Networked Social Ties and Co-Location (NEST-CL) Survey: A Novel Method for Capturing Complex Social Networks	Daisuke kajiyama, Makoto Chikaraishi	Hiroshima University; Hiroshima Daigaku
3	PP3991	Optimization of Intercity Multimodal Network Considering Different Travel Behaviors Estimated via Non-negative Matrix Factorization	Manh Hung Manh NGUYEN, M.D; Hiromichi YAMAGUCHI	Kanazawa University Graduate School of Natural Science and Technology; Kanazawa Daigaku Daigakuin Shizen Kagaku Kenkyuka
4	PP3926	Bottleneck Capacity Optimization Model Considering Network-level Dynamic Evacuation Traffic	Kenshiro OSHIMA, B.E.; Ryuichi TANI; Kenetsu UCHIDA	Hokkaido University Faculty of Engineering; Hokkaido Daigaku Kogakubu Daigakuin Kogakuin Kogaku Kenkyuin
5	PP4049	Optimization-Based Methodology for Comprehensive Sustainability Analysis of Intercity Passenger Transportation Network	Satoshi Motoki; Makoto Okumura	Tohoku University; Tohoku Daigaku

Session 7, Session Number 58 (11:00-12:30)

Session Chair: Porntep Puangprakhon

NO	PAPER ID	TITLE	AUTHOR	AFFILIATION
1	PP3970	Utilization of microcontroller-based ultrasonic sensor in railway crossing safety system	AGIL ANZAS SAPUTRA, AGUNG DWI KURNIANTO, FAREL GOGO MULIA, Wahyudi Meynanda Oriuwatu, SRI SARJANA	POLITEKNIK TRANSPORTASI DARAT INDONESIA
2	PP4030	Large Language Models used in traffic accident data extraction from narrative report	Naranbaatar Erdenesuren; Ariunbayar Samdantsoodol	Mongolian University of Science and Technology
3	PP4216	Estimating the Critical Gap for U-Turns at Uncontrolled Median Openings	Porntep Puangprakhon, Ph.D.; Walairat Bunthai	Mahanakorn University of Technology
4	PP4107	Perception and Response of West Sumatra Society to the Planned Implementation of the Demerit Point System in Traffic Violation	Purnawan Purnawan, Ph.D	Universitas Andalas
5	PP4155	Safety Measures in a Roundabout with High Motorcycle Traffic: A Case Study at Prince of Songkhla University	Shogo Arakawa; Noriyasu TSUMITA; Piyapong SUWANNO; Chaiwat YAIBOK; Paramet LUATHEP; Atsushi FUKUDA	Kanazawa University

NO	PAPER ID	TITLE	AUTHOR	AFFILIATION
1	PP4467	Exploring Factors Influencing First-Mile And Last-Mile Connections To Public Transport From Car Users' Perspective	Eugene Sogbe, Susilawati Susilawati, Graham Currie, Chee Pin Tan	Monash University Malaysia
2	PP4221	What are the likely access modes to future metro rail stations? A stated preference choice experiment of Mumbai commuters	Mandar Vaidya; Arkopal K Goswami	Indian Institute of Technology Kharagpur
3	PP3861	Bus Route Planning using Dijkstra Algorithm: A Case Study of the Public Bus System in Phnom Penh	Narith Saum; Sokhit Plack; Piseth Srorn; Davy Vin; Vong Panharith Ek	Institute of Technology of Cambodia
4	PP3951	Impact of the Phased Implementation of Dhaka MRT Line 6 on Road Traffic	Hisanari Ushirooka; Satoru KOBAYAKAWA; Mahfuja AKTAR	Nippon Koei
5	PP4168	Public Transport Policies in Motorcycle-Dependent Cities: A Systematic Review of Strategies and Challenges	Riza Suwondo; Tory Damantoro; Djoko Setjowarno; Qadriathi Bau; Putu Alit SUTHANAYA	Binus University

Session 6, Session Number 51 (09:00-10:30)

Session Chair: Varameth Vichiensan

NO	PAPER ID	TITLE	AUTHOR	AFFILIATION
1	PP4057	Impact of Typhoon-Induced Flooding on Traffic Patterns and Vehicle Mix: A 24-Hour Analysis of Metro Manila's Gregorio Araneta Avenue	Lance Kenneth Diaz Mamuyac, Louise Shaola LUMANGLAS, Alexis FILLONE	De la Salle University
2	PP4321	Driving Sustainable Transport through Tree Planting and Renewables; A Synergistic Approach to Climate Mitigation	Majid Ali, Chaur-Luh Tsai	National Kaohsiung University of Science and Technology - Nanzih Campus
3	PP4317	Green Transformation of Japan's Transport Industry - Recommendations Based on Scenario Analysis	Masanobu TANIGUCHI; KATO Yuta; KOKURA Shoto; SUGO Yasushi; FUJISAKI Koichi; YAMAUCHI Hirota	The Japan Transport and Tourism Research Institute
4	PP4092	The Paradox of Natural Stone Pavements in Hanoi: Exploring Environmental, Societal, and Economic Impacts on Sustainable Urban Development	Le Dinh PHUOC; Dinh Tuan Hai; Trinh Thi PHIN	Hanoi Architectural University
5	PP4355	Evaluating the Impact of Urban Flood Adaptation Measures on Mode Share and Road Traffic in Bangkok	Varameth Vichiensan, Ph.D.; Vasinee Wasuntarasook	Kasetsart University Faculty of Engineering

Session 7, Session Number 59 (11:00-12:30)

Session Chair: Abdul Azeez Kadar Hamsa

NO	PAPER ID	TITLE	AUTHOR	AFFILIATION
1	PP4176	Analysis of the Pedestrian Infrastructure and Pedestrian Volume at Setiawangsa LRT Station	Abdul Azeez Kadar Hamsa, Ph.D.; Nik Nurul Aziemah Nik Othman	International Islamic University Malaysia
2	PP3871	Prioritizing Utility-based Cycling Attributes for Sustainable Urban Mobility in Jaipur, India	Krati A Maheshwari; Manan Monga, MURP; Shubhajit Sadhukhan	Indian Institute of Technology Roorkee
3	PP4228	Bridging between Perceived Walkability and Urban Design Perspectives: Context-Specific Insights from Jakarta, Indonesia	Yuma TSUMURA; Hideo SHIRAISHI; Agustina Martha KIMBERLY; Hirohisa KAWAGUCHI; Yola Yodya PRATIWI; Shinya HANAOKA	Institute of Science Tokyo
4	PP4009	Assessing Walkability in Kathmandu Metropolitan City Through Urban Density and Land Use Diversity Using GIS-Based Analysis	Padma Bahadur Bahadur SHAHI; Aakash Pradhan	Kathmandu University
5	PP4313	Person-Environment Fit Theory In Urban Walking: An Evaluation Of Subjective Influences And The Mediating Role Of Safety And Security	Eugene Sogbe, Susilawati Susilawati, Becky Loo, Graham Currie, Chee Pin Tan	Monash University Malaysia

NO	PAPER ID	TITLE	AUTHOR	AFFILIATION
1	PP4301	Smart Mobility in Metro Manila: Evaluating Readiness and Potential Through a Tailored Index	Jemima Ann Ebin Ado; Naohiro KITANO; Akinori MORIMOTO	Waseda University; Waseda Daigaku
2	PP3880	Analysis of Car Sharing Membership Behavior in Japan Considering Access to Car Sharing Stations	Kazuya Mitani; Toshiyuki Yamamoto	Nagoya University; Nagoya Daigaku
3	PP4158	Users' Matching Preferences and Use Intentions in a Community Ridesharing System	Motoki TAKAI; Makoto Chikaraishi; Akimasa FUJIWARA	Hiroshima University; Hiroshima Daigaku
4	PP4349	Examining the Use of Food Delivery Services and Its Impact on Food Shopping Behavior in the Urbanized Area of Yogyakarta, Indonesia	Yori Herwangi	Universitas Gadjah Mada

Session 6, Session Number 52 (09:00-10:30)

Session Chair: Chun Hwee Lee

NO	PAPER ID	TITLE	AUTHOR	AFFILIATION
1	PP3852	Benchmarking Road Safety: A Global Comparative Analysis Based on Economic and Mobility Modes	Chun Hwee Lee; Naohiro Kitano; Akinori Morimoto	Waseda University - Nishiwaseda Campus: Waseda Daigaku - Nishiwaseda Campus
2	PP3935	Work Commuting: Risky Riding Behaviors among Malaysian Industrial Workers	LILIS SURIENTY ABD TALIB, PhD; Yin Kong VOON; Hasrina MUSTAFA; Ahmad Farhan MOHD SADULLAH; Nur KASEHYANI	Universiti Sains Malaysia School of Management: Universiti Sains Malaysia Pusat Pengajian Pengurusan
3	PP4165	Dynamic Examination of Traffic and Safety Flow Between Human-Driven Vehicles and Cautious Autonomous Vehicles	Maftuh Ahnan; Dukgeun Yun	University of Science and Technology, KICT School
4	PP3939	The analysis of accident risk factors based on the similarity between the contribution distribution of accident risk prediction models and traffic state contour maps	Takahiro Tsubota, Shinichiro Yabata	Ehime University
5	PP4175	Assessing Risk Sensitivity of Pedestrian and Driver Behaviors at Unsignalized Crosswalks Using Microscopic Traffic Simulation	Hasara Senevirathna, Master of Science Program in Engineering and Techn; Mongkut Piantanakulchai	Thammasat University Sirindhorn International Institute of Technology

Session 7, Session Number 60 (11:00-12:30)

Session Chair: Kyaing

NO	PAPER ID	TITLE	AUTHOR	AFFILIATION
1	PP4169	Pedestrian Accidents in Yangon: A Comparative Analysis Before, During and After COVID-19 and Unified Data	Kyaing; Nuzin Aung Htay; Honey Htun Tin; Ann Grace; Nanda Kyaw Win; Thurain Aung Kyaw	Yangon Technological University
2	PP3889	Identification of Black Spots for Pedestrian Accident in Yangon	Nuzin Aung Htay, ME; Nuzin AUNG HTAY; Kyaing; Nanda KYAW WIN; Thurain AUNG KYAW	Yangon Technological University
3	PP4051	MAXIMIZING PEDESTRIAN SAFETY AND EFFICIENCY: SOCIAL FORCE MODELING OF BOTTLENECK EFFECTS IN EVACUATION THROUGH UNIDIRECTIONAL HALLWAYS	Ratana Poonyathanasakchai, M.D.; NATACHAI WONGCHAVALIDKUL	Mahidol University Faculty of Engineering
4	PP3844	Pedestrian Impatience and Its Impacts on Gap Acceptance Decisions at Unrestricted Crossings	Prashant KUMAR, Subhadip BISWAS	National Institute of Technology Silchar
5	PP4045	Acceptability of Traveling Vehicle Mass Management on Residential Roads	Yasuhiro Mirumura; Motohiro Yamazaki	Oita University

Session 8, Session Number 67 (13:30-15:00)

Session Chair: Sakine Takai

NO	PAPER ID	TITLE	AUTHOR	AFFILIATION
1	PP4359	The Impact of Digital Service Substitution and Social Networks on Residential Location Choice	Daiki Suzuki; Mustafa MUTAHARI; Nao SUGIKI; Kojiro MATSUO	Toyohashi University of Technology; Toyohashi Gijutsu Kagaku Daigaku
2	PP4198	Do Travel and Location Attitudes Differ Between Households Seeking Rental and Ownership Housing	Preety Saini; Debapratim Pandit	Indian Institute of Technology Kharagpur
3	PP4174	Residential Relocation Intentions Based on Environmental Service Levels: Implications for Suburban Compact City Strategies in Sapporo	Sakine TAKAI; Kunihiro KISHI; Shin-ei TAKANO	Hokkaido University; Hokkaido Daigaku
4	PP4219	Assessing the Impact of Market Relocations on Mobile Vendors Considering Cooperative and Non-Cooperative Behaviours	Triana Sharly Permaisuri Arifin; Chandra Balijepalli; Anthony Whiteing	University of Leeds Institute for Transport Studies
5	PP4428	Analysis of Traffic Control Measures During the Hiroshima G7 Summit and Their Impact on Residents and Businesses	YOJI YAMAMOTO; Yusuke Kanda; Akimasa Fujiwara; Hidetaka Mori	National Institute of technology, Kure college

POSTER ID	TITLE	AUTHOR	AFFILIATION
PP4263	Spatial Crime Analysis of Bicycle Theft: Regression Models and Nonlinear Effects	Naoki Ohashi; Masanori AJITO; Shintaro TERABE; Hideki YAGINUMA	Tokyo University of Science: Tokyo Rika Daigaku
PP4403	Assessing the Potential Utilization of POI Data for Zone Formulation in Detailed Spatial Plans	Zahra Witsqa Maghfira, B.Eng; Tao Feng	Hiroshima University: Hiroshima Daigaku
PP4138	Study on Classification Method for Bike Sharing Stations considering Temporal Demand Variations	TAKASHI MIYAZAWA; Kazuyuki TAKADA	Tokyo Denki University
PP4195	Strategic Fleet Composition for Container Vessels: Achieving Net-Zero Emissions Through Alternative Fuels and Speed Reduction	Anne Xaviera Go; Tomoya KAWASAKI; Rei MIRATSU; Ryuji MIYAKE	University of Tokyo: Tokyo Daigaku
PP4137	Demand Forecasting for Demand-Responsive Transportation using Machine Learning: A Case Study of Higashimatsuyama City	Taiki Mukoyama; Kazuyuki Takada	Tokyo Denki University
PP4284	Research on the Practical Application of Sightseeing Verbal Map in China: Examining Cross-Cultural Differences in Verbal Navigation Aids for Visually Impaired	Tianyu Li; Takashi Uchida	Osaka Metropolitan University
PP4156	Effective travel time surplus maximization stochastic user equilibrium model considering travel time reliability	SHUNSUKE ABE; Ryuichi Tani; Kenetsu Uchida	Hokkaido University Faculty of Engineering
PP4294	Exploring preferences toward adopting autonomous vehicles via a hybrid rank-ordered logit choice model	Yayu Hsu; Ching-Fu Chen; Chin-Hsiang Lin	National Cheng Kung University
PP4430	Visual Perception and Ergonomic Influences: Assessing Blind Spot Variability and Distance Estimation Through Side-View Mirrors of Passenger Car	Anik Barat, Sanhita Das	Indian Institute of Technology Roorkee
PP4105	Research on the Relation between Driving Operations and Cognitive Function of Elderly Drivers	Runa Saito; Manato TOYODA; Kazuyuki Takada; Kota MIYAUCHI; Moeko NOGUCHI-SHINOHARA	Tokyo Denki University
PP4287	Measuring Drivers Stress Responses During Encounters with Aggressive Driving	Akimasa FUJIWARA; Mahiro TSURUZONO; Miho SEIKE; Makoto CHIKARAISHI	Hiroshima-University

POSTER ID	TITLE	AUTHOR	AFFILIATION
PP3973	Causal Inference on the Effects of Continuous Grade Separation Projects on the Population of Station Areas	Ryo Kondo; Shintaro Terabe; Hideki Yaginuma; Masanori Ajito	Tokyo University of Science - Noda Campus: Tokyo Rika Daigaku - Noda Campus
PP4210	Study on Shape of Speed Humps According to Speed Limits Using Riding Experiments and Vehicle Vibration Simulation	Toma Masatani; Aya Kojima; Hisashi Kubota	Saitama University Graduate School of Science and Engineering: Saitama Daigaku Daigakuin Rikogaku Kenkyuka
PP4392	Basic Research on Shoulder Operation Measures on Expressways	Kenta YANAGIMACHI; Kazuyuki Takada	Tokyo Denki University
PP4434	Exploring the Inter-District Travel Pattern in Bangladesh using Longitudinal Travel Survey	Tasnim Naher Bushra, B.Sc; Annesha Enam	Bangladesh University of Engineering and Technology
PP4010	Mobile Grocery Store Shopping and Its Impact on Social Interaction	Noboru Ise; Wan Suhaimi; Takeshi Hirose; Emi Minato	FUJITSU SYSTEMS GLOBAL SOLUTIONS MANAGEMENT SDN. BHD.
PP4376	Operational and Financial Assessment of Metro System in India: A Data Envelopment Approach	vinayak gaur, M.Tech; Gopal R. Patil	Indian Institute of Technology Bombay
PP3855	Estimating Bus Passenger Counts Using Wi-Fi Packet Sensors A Background Noise Cancellation Approach	Momoka OZONO; Shintaro TERABE; Hideki YAGINUMA; Masanori AJITO	Tokyo University of Science - Noda Campus
PP4356	Evaluating the Operational Performance and Accessibility of Trans Metro Pasundan Corridor 2D in the City of Bandung	Rainier Zhafari Alhamdi, B.E.; Widyarini WENINGTYAS; Harun Al Rasyid Lubis	Institut Teknologi Bandung
PP4417	Evaluating Special Event Transit Demand and Quantifying the Gap between Demand and Supply: A Case Study of Mahakumbh Mela, One of World's Largest Human Gathering	Shambhavi Sinha; Agnivesh Pani; Varun Varghese	IIT BHU: Indian Institute of Technology BHU Varanasi
PP4235	On-Demand Autonomous Vehicle Bus Route Planning: A Theoretical Probe for Mawson Lakes	Li Meng; Shun YAO; Wenhao LIU; Philip BLAKE	University of South Australia
PP4204	Harnessing Machine Learning for Analyzing Key Attributes of MaaS and PID in Inland Water Transport Ridership	Yogeshwar V. Navandar; Jijin A; Bivina G R; Krishnamurthy K	NIT Calicut, India

Poster Session A (Young Researchers) 13:30-15:00

POSTER ID	TITLE	AUTHOR	AFFILIATION
PP3910	Analyzing Regional Travel Mode Choice Behavior: A Study on Regional Rapid Transit System (RRTS) Adoption in Delhi NCR	Gajanand Sharma, Anshul Singh, Arkopal Goswami	Indian Institute of Technology Kharagpur
PP4454	Non-Destructive Testing Techniques for Asphalt Pavement Density Measurement: A Review and Potential Applications in Vietnam	Tien Dung Chu; Xuan Chieu LUONG; Quang Phuc NGUYEN	University of Transport and Communications
PP4262	Development of an Artificial Neural Network Model for Predicting Flexible Asphalt Pavement Elastic Modulus	Tien Dung Chu; Quang Phuc Nguyen; Xuan Chieu Luong	University of Transport and Communications
PP4412	Sustainable Utilization of Manufactured Sand in Hybrid Fiber-reinforced Cementitious Composites: Environmental, Economic, and Durability Analysis	Chandrasekhar Chintada; G.D. Ransinchung	Indian Institute of Technology Roorkee
PP3958	Volumetric Property Adjustments for Enhanced Performance of Recycled Asphalt Concrete	Jian-Shiuh Chen	National Cheng Kung University
PP4401	Investigation of the Unconfined Compressive Strength Characteristics of Saline Soil Stabilized by Mixing with Cement and DHD Additive	Xuan Quy Le; Huy Nghia NGUYEN; Van Binh TRAN	University of Transport and Communications
PP4357	A Structural Performance Analysis of Carboncor Asphalt for Sustainable Road Construction	Xuan Quy Le	University of Transport and Communications

Poster Session B (Young Researchers) 15:30-17:00

POSTER ID	TITLE	AUTHOR	AFFILIATION
PP4307	Integration of Local Wisdom and Green Technology in Sustainable Transportation Planning in Indonesia (Surabaya City)	IB Ilham Malik; Erina Noviani; Regita Cahyani Yasmiin	ITERA: Institut Teknologi Sumatera
PP4086	Determinants of Active Transport in Emerging Megacities: A Bayesian Belief Network Framework for Sustainable Mobility Solutions	Kashfi SHARAF; Email Haque MUNMUN; Md. Shafiul Islam AKASH; Syed Navid WALI; Md Asif RAIHAN; Moinul Hossain	Islamic University of Technology
PP4328	The Development of Winter Tourism in Mongolia	Amartuvshin Lkhagvasuren, PhD; Chuluuntsetseg Lkhagvasuren	Mongolian University of Science and Technology

POSTER ID	TITLE	AUTHOR	AFFILIATION
PP4026	Pilot Duty Time Policy Measures: a Meta-analysis Approach	Barbara T.H. Yen, Ph.D.; Voda W.C. LIN; Jin-Yuan Wang	National Yang Ming Chiao Tung University
PP4212	STREET DESIGN FOR POINTS ON SIDEWALKS WHERE CONFLICTS BETWEEN VEHICLES AND PEDESTRIANS MAY OCCUR	Tatsuya Arai; Aya Kojima; Hisashi Kubota	Saitama University Graduate School of Science and Engineering; Saitama Daigaku Daigakuin Rikogaku Kenkyuka
PP4188	Evaluation of Traffic Accident Risk at Unsignalized Intersections on Residential Roads using 3D models	Rika Arasawa; Shuhei KANEKO; Kanta IIMURO; Kazuyuki Takada	Tokyo Denki University
PP4059	Analyzing Roundabout Safety under Mixed Traffic: A Bivariate EVT-POT Approach	Abhijnan Maji; Indrajit Ghosh	Indian Institute of Technology Roorkee
PP4303	Safety Assessment of Highways using Two-Stage modelling of Crash Frequency and Severity	Kommoju Prathyusha, Indrajit Ghosh, Amit Agarwal	Indian Institute of Technology Roorkee
PP4272	ROAD GEOMETRIC SAFETY AND SPEED CONSISTENCY AUDIT ON EXIT RAMP 43 ON THE CINERE - JAGORAWI HIGHWAY TOLL ROAD	Benedictus Bimo Pradipto, Bachelor of Civil Engineering; Martha Leni Siregar	Universitas Indonesia
PP3969	Integrating AI Algorithms and GIS Technology for Traffic Accident Prediction: Towards Safer Roads Through Advanced Modeling	Khanh Giang Le; Quang Hoc TRAN	University of Transport and Communications, Hanoi
PP4077	Community Perception Of The Use Of White and Yellow Headlamps On Four-Wheeled Vehicles Towards Driving Safety (Case Study: Bedugul Highway, Bali)	Rahmat Ahmad, M.T; Aris Budi Sulisty; I Wayan Yudi Martha Wiguna; Anggun Prima Gilang Rupaka; Arif Devi Dwipayana	Bali Land Transport Polytechnic
PP4124	Factors Affecting Traffic Accident Severity on Expressways: Evidence from Vietnam	Tien Dung Chu; Xuan Quy LE	University of Transport and Communications
PP4126	Modern Perspectives on Highway Geometric Design: Accounting for Driver Perception – A Review	Tien Dung Chu; Van Hung NGUYEN	University of Transport and Communications
PP4315	Identifying Dangerous Driving Behaviors on the Vietnamese Expressway System	Tien Dung Chu	University of Transport and Communications
PP4033	Characteristics of and Current Countermeasures against Wrong-Way Driving on Japanese Expressways	Hiroaki Sakamoto; Katsuhiro IIDA; Jian XING; Hodaka KAI	Nippon Expressway Research Institute Company Limited

POSTER ID	TITLE	AUTHOR	AFFILIATION
PP4261	Post-Redevelopment Circulation and Streetscape Evaluation: A Case Study of Maebashi City, Japan	Ryusei Yoshihara; Masanori Ajito; Shintaro Terabe; Hideki Yaginuma	Tokyo University of Science: Tokyo Rika Daigaku
PP3906	Case Study on the Linear Chuo Shinkansen, Japan: Environmental and Economic Impacts Using a Spatial Computable General Equilibrium Model	XINGWEI LIU; Yihao XU; Shinichi MUTO	WASEDA University
PP3915	A Study of Economic Activities in the Small and Medium-sized Cities with HSR Local Stations	Rintaro Shimomura, Master; Naoyuki TOMARI; Hajime INAMURA	Tohoku Institute of Technology: Tohoku Kogyo Daigaku
PP3931	Simulation of Land Use Change and Urban Development Based on Spatial and Transportation Interaction in Padang City for 2043	Alkinol - Farezki, B.URP; IB Ilham Malik; Valendya Rilansari	Institut Teknologi Sumatera
PP3870	Do Green Spaces Promote Sustainable Transportation? Insights from Personal Travel Experiences in Japan	Qiaoyu Pan; Kuniaki SASAKI	Waseda University Faculty of Science and Engineering: Waseda Daigaku Riko Gakujutsuin
PP4196	Transportation SuperApps and Urban Foodscapes: A Comparative Spatial Analysis of Online Food Merchant Distribution in Jakarta, Bandung, and Medan	Hafiyyan Hilmy Fawwaz, B.Sc.; Maya Safira; Makoto Chikaraishi	Hiroshima University: Hiroshima Daigaku
PP4011	Extracting ODs with Arrival-Time Constraints from Conversations in Urban Expressway Call Centers	Yu Yamashita; Shintaro TERABE; Takayuki MIZUNO; Hideki YAGINUMA; Masanori AJITO	Tokyo University of Science - Noda Campus
PP4453	Developing a Prediction Model for On-Street Parking Choice Behavior using SVM Machine Learning: A Case Study in Hanoi	Che LE Van; Minh Tan DANG, Ph.D.	University of Transport and Communications
PP4068	Causal Effect of Neighborhood Park Development on Urban Liveliness	Keito Yamaguchi; Xueqing BO; Shintaro TERABE; Masanori AJITO	Tokyo University of Science - Noda Campus
PP4233	Illegal Parking Behavior at Pub-Street and Night Market Area, Siem Reap	Panha Yang, M.D.	Institute of Technology of Cambodia
PP4379	Impact of Vehicle Dynamics and Streetscape Features on Traffic Conflicts: A Connected Vehicle-Based Approach	Yaqiu Li; Haoran Li; Akimasa Fujiwara	Hiroshima University

POSTER ID	TITLE	AUTHOR	AFFILIATION
PP4346	Spatial Analysis of Land Use Changes and Hydrological Impact of Railway Infrastructure Development on the Western Coast of South Sulawesi, Indonesia	Munajat Nursaputra; Andang Soma	Hasanuddin University
PP3853	Proactive Safety Analysis of Urban Intersections Using the Traffic Conflict Technique and SSAM Approach: A Case Study in Tashkent City.	Bekzod Turatov, Master of Engineering; Shinji TANAKA; Sherif SHOKRY	Yokohama National University
PP4353	Development of a Simulation System for Predicting Traffic and Parking Congestion at Famous Tourist Destinations	Karin Watanabe; Yusuke Kanda	National Institute of Technology, Kure College

POSTER ID	TITLE	AUTHOR	AFFILIATION
PP3924	Modeling of Pedestrian Safety in School Zones Based on Behavioural Risk	R. Manisha; Anusha S P; Jerrin Thomas Panachakel; G.R. Bivina	College of Engineering Trivandrum
PP4018	Understanding Pedestrians Attitudes and Perceptions Towards Road Safety: A Case Study of Jakarta, Indonesia	Vania ASBAHANY; Shahana AVATHKATTIL; Sahana BENNETT; Priyantha WEDAGAMA; Dilum Deepika Abeyakone DISSANAYAKE	University of Birmingham Edgbaston campus: University of Birmingham
PP4240	Understanding the Shared Risk: A Questionnaire Survey of Pedestrian and Driver Safety Concerns at Street Crossings in Motorcycle-dependent cities	Minh Tan DANG, Ph.D	University of Transport and Communications
PP4341	Analysis of Cyclists' Behavior and Safety at Roundabouts with Different Geometric Designs	Naoto Inaoka; Koji SUZUKI	Nagoya Institute of Technology
PP3998	Data-Driven Traffic Management: Implementing YOLOv8 for Vehicle Detection and Classification in Mixed Traffic Conditions	Putu Eka Suartawan; Aswin Badarudin; Riz Oktavianus Sasue; Dewa Wedagama; Putu Suthanaya; I Suraharta	Politeknik Transportasi Darat Bali
PP3888	Improving GPS-Based Travel Surveys Data: Acceptability, Immobility and Missing data	Thanh Tu Nguyen; Jean-Loup Madre	University of Transport and Communications
PP4094	A Novel Prediction Model of Passengers Arrival at Airport Check-in Counters	Yu-Chiun Chiou; Fu-Hua CHANG	National Yang Ming Chiao Tung University
PP4017	Understanding Attitudes and Perceptions of Motorcyclists and Car drivers Towards Traffic Safety: A Case Study of Hanoi, Vietnam	Hanh NGUYEN; Shahana AVATHKATTIL; Sahana BENNETT; Priyantha WEDAGAMA; Dilum DISSANAYAKE	University of Birmingham Edgbaston campus: University of Birmingham
PP4289	Measurement of the hazard perception ability of elderly motorcyclists	Chi-Hung Evelyn WU, Ph.D.; Feng-Yi HSU	National Taiwan Ocean University
PP4160	Improvement of Inland Water Transport Service Based on Users' Perception	Vaishnavi Pidathala; Bhargab Maitra; Pulak Mishra	Indian Institute of Technology Kharagpur
PP4093	The Effectiveness of Average Speed Enforcement Systems in Taiwan	Pin-Yi TSENG, Ph.D.	Central Police University
PP4255	Evaluating the Impact of Bulb-out on Driver Behavior and Perception at Midblock Crosswalks Under Varying Visibility Constraints	Beatrice Mariano Buenvenida; Azusa TORIUMI; Takashi OGUCHI	University of Tokyo

POSTER ID	TITLE	AUTHOR	AFFILIATION
PP4482	Driving Behavior Survey on a Mountainous Multi-Lane Highway	Napon Srisakda, Ph.D.; Sorawit Narupiti	University of Phayao
PP4050	Post COVID-19 behavioural changes in First-Last Mile travel and perception on service quality of public transport	Vishwajeet Kishore Verma, Ph.D; Rajat Rastogi	Indian Institute of Technology Roorkee
PP4110	How Travel Time, Cost, and Attitudes impact Travel Behaviour in Developing Countries: A case study in Bangkok, Thailand	Dilum DISSANAYAKE;Titayapa Meenapinunt; Margaret Bell ;Gustav Bösehans	University of Birmingham
PP4382	How Do Riders Perceive and Prioritize Segregation Devices in Exclusive Motorized Two-Wheeler Lanes? A Simulator-Based Study	Harish Kumar Saini; Ankit Kathuria	Indian Institute of Technology Jammu
PP4285	How does travel affect adolescents' subjective well-being: Dependency on travel modes usage in Bali, Indonesia.	I Made Sukmayasa, M.Sc; Jaime Soza-Parra; Dick Ettema	Utrecht University
PP4423	Analysis of Factors Affecting Public Acceptance of Autonomous Shuttle Travel Service in India	Ankit Singh; Rajalakshmi Pachamuthu; Digvijay Pawar	Indian Institute of Technology Hyderabad
PP4456	Important Factors to Influence the Pollution of Cruise Port	Rong-Her Chiu; Chun-Hsiang CHANG; Tze-Hsuan CHIU	National Taiwan Ocean University
PP4208	How Should Asian Ports Approach to Build the Supply Chain for New Energy: A Comparison to European Ports	Keigo Okano; Yumei MINAMI; Tadasuke ISOYAMA; Jun KIMATA Masaki MIMURA; Mikio TAKEBAYASHI	Chuo Fukken Consultants Co., Ltd.
PP3864	Is Travel Market Dispersion Beneficial for the Resilience of Tourism Destinations? Lessons from COVID-19	Sayaka Shinjo; Takeshi Kurihara	Toyo University
PP3971	Construction of Risk Assessment Model for Maritime Autonomous Surface Ship Using Fuzzy Cognitive Map	Chien-Chang Chou; Yu-Kai Huang; Jun TOYOTANI; Cheng-Hsien HSIEH; Ching-Wen SHIH	National Kaohsiung University of Science and Technology - Cijin Campus
PP4475	Unveiling the paths to the continuous use of light rail services in Taiwan: A PLS-SEM/fsQCA approach	Ruo Yu Huang, Hsun Ting LIU, Zi En HUANG	National Cheng Kung University
PP4474	Public Transport Promotion Effect Measurement: Monthly Pass (TPASS) Case Study in Taiwan	Barbara T.H. Yen, Ph.D.; Chia-Jung Yeh; Yu-Chiun Chiou; Chin-Chih Liao; Chin-Tung Tsai	National Yang Ming Chiao Tung University

POSTER ID	TITLE	AUTHOR	AFFILIATION
PP4113	Assessing Elderly Users' Perceived Level of Satisfaction towards Public Transportation	Musharraf KHURSHID; DARSHANA OTHAYOTH, Ph.D; Dilum DISSANAYAKE	University of Birmingham Edgbaston campus
PP4397	Shaping Park Visitation: Motivational Insights from Parents with Children: A Systematic Review	Daun Yun; Bingyu Zhao; Susann Ahn	TU Wien Vienna, Vienna AUSTRIA
PP4415	Analysing Travel Satisfaction Determinants of Pilgrims Based on a Motivation-based Segmentation Approach: A Case Study of Mahakumbh Mela, India	Agnivesh Pani; G M Hridya; Varun Varghese	Indian Institute of Technology BHU Varanasi
PP4419	Modelling the Intention to Use Aerial Ropeway Transit as an Emerging Urban Mobility Solution: A Case Study of Varanasi, India	G M Hridya; Devang Sharma; Agnivesh Pani; Dr. Ankit Gupta	Indian Institute of Technology BHU Varanasi

POSTER ID	TITLE	AUTHOR	AFFILIATION
PP3946	Road Traffic Safety in Mongolia: Trends, Challenges, and Solutions (2014-2023)	Bayarsaikhan Bayasgalan, Ph.D; Ganjargal Osorkhuu	Mongolian University of Science and Technology Akita University
PP4019	A Study on Safety Measures at the Two-Lane Expressway with Wire Rope in Japan	Hidekatsu HAMAOKA; Shunya ABE	Hiroshima University
PP4275	Impact of On-street Wireless Charging Systems at Intersections on Route Choices behavior of Electric Motorcycle Users in Phnom Penh	Beang PHALKUN; Akimasa FUJIWARA	Tokyo Institute of Technology School of Environment and Society: Tokyo Kogyo Daigaku Kankyo Shakai Rikogakuin Nihon University
PP4065	Crash Risk Assessment in a Mixed Traffic Environment of Autonomous and Human-Driven Vehicles	Sultana Rajia, Ph.D.; Haruki NAKA; Yasunori MUROMACHI; Moinul HOSSAIN	Mongolian University of Science and Technology
PP4037	Assessing a Traffic Capacity Estimation Method for T-Shaped Stop-Controlled Intersections Using Field Data	Keisuke YOSHIOKA, Tomoyuki TODOROKI	
PP4056	Enhancing Intersection Efficiency in Ulaanbaatar: Insights from a VISSIM-Based Analysis	Nyamdulam Tsoodol; Ariunbayar Samdantsoodol; Naranbaatar Erdenesuren	

POSTER ID	TITLE	AUTHOR	AFFILIATION
PP4201	Identification of Crash Severity for Heterogeneous Heavy Vehicle Data – A Case Study of Freeways No. 1 & No. 3 in Taiwan	Shou-Ren Hu, Ming-Jie Shih	National Yang Ming Chiao Tung University
PP4399	Applying International Classification of Diseases (ICD) Code to Analyze Injury Severity of Traffic Crash Victims	WAN HUI CHEN, Ph.D.; Han-Ju TSAI	Tamkang University
PP3943	Methodology for Determining the Initial Speed of Vehicle Collisions Based on Deformation Energy Analysis	Ganjargal Osorkhoo, M.D; Bayarsaikhan Bayasgalan	School of Mechanical and Transportation Engineering
PP4125	The Green Light Dilemma: What Influences Driver Decisions at Signalized Intersections?	Tien Dung Chu, Ph.D	University of Transport and Communications
PP4087	Understanding Crash Risk on Highways: The Impact of Land Use, Encroachment and Built Environment	Naba UDDIN; Anika TASNIM; Ahnaf RAFI; Md Asif RAIHAN; Moinul Hossain	Islamic University of Technology
PP3942	Influence of Roadway Curvature on Two-Wheeler Rider Kinematics and Safety in Urban Environments: A Case Study	Samuel Peter Chadalavada, M.Tech; S V Subbarao Saladi	Mongolian University of Science and Technology
PP4118	Spatial Analysis of Traffic Accident Factors in Balikpapan City	Arief Hidayat; Maylani Simanungkalit	Tokyo University of Science
PP4063	Applicability of Anomalous Driving Detection Methods to Driving Safety Management	Kota Miyauchi; Kazuyuki TAKADA; Manato TOYODA; Runa SAITO	The Institute of Behavior Science
PP4064	Review of Development Trends of Anomalous Driving Detection Technologies Providing Driving Support	Kota Miyauchi; Kazuyuki TAKADA	The Institute of Behavior Science
PP4270	Comparison of Ordinary Least Squares, Poisson, and Negative Binomial Models in Expressway Traffic Accident Prediction: A Case Study in Vietnam	Xuan Quy Le; Tien Dung Chu	University of Transport and Communications
PP4146	Distracted Driving Across Vehicle Types: A Comparative Analysis Between Two-Wheelers and Cars	Samuel Peter Chadalavada; Rahul SODADASI	Mahindra University
PP4194	Analysis of Willingness to Accept Constraints in Electricity Demand Response with Commuters ■ Electric Vehicles at Workplace	KYOKO OKOSHI; Terumitsu HIRATA; Haruka UNO; Shiori AKATSU; Ryusuke MIURA	Ibaraki University; Ibaraki Daigaku

POSTER ID	TITLE	AUTHOR	AFFILIATION
PP3997	The influence of vehicle age and traffic congestion on air pollution in Ulaanbaatar: A study of NO and PM emissions	Delgernasan Mishig, Ph.D; Mrs.Altantstetseg Tsedev, Senior lecturer; Mr. Bum-Erdene Ganzorig, MSc student	Mongolian University of Science and Technology
PP4097	Application of Wi-Fi Packet Sensors for Real-Time Visitor Estimation During Large-Scale Events	Manik Mondal; Shintaro TERABE; Hideki YAGINUMA	Tokyo University of Science
PP4075	Evaluating Walkable Communities: The Walking Propensity Index in Tokyo	Yuya NIIKURA; Shintaro TERABE; Hideki YAGINUMA	Tokyo University of Science
PP3868	The Impact of Employee Engagement on Sustainable Transport Development	Ayush ANDRYEI, Ph.D; Mrs. Delgernasan MISHIG; Mrs.Nomungerel ERDENEBAT	Mongolian University of Science and Technology
PP4334	Spatial Analysis of the Relationship Between Disaster Exposure and Land Use: The Case of Young Female Population in Municipalities at Risk of Vanishing, Japan	Jun Sakamoto, Ph.D.	Kochi university
PP4060	Relationship between urban environment and changes in health among Returning Drivers of Drivers' Licenses	YU SUZUKI, HIROKI SETOGAWA, SHINTARO TERABE, HIDEKI YAGINUMA, HARUKA UNO	Hokkai-Gakuen University
PP4046	Urban Mobility during Heavy Snowfall, Analyzed by Mobile Spatial Statistics Data	Makoto Okumura, D.Eng.; Yuri Sawamura; Hiromichi Yamaguchi	Tohoku University; Tohoku Daigaku
PP4391	Transit-Induced Urban Transformation: Land Use and Land Cover and Land Surface Temperature Dynamics Across Delhi's Metro Line Influence Zones	Akimasa FUJIWARA; David XAVIER Blessy	Hiroshima University
PP4340	Quantifying the Impact of Transit-Oriented Development on Travel Behavior: Evidence from the Jakarta Metropolitan Area	Alyas Widita; Mori HIROMITSU	Monash University Indonesia
PP4329	Institutional Roles and Future Prospects for TOD Promotion in Jakarta Metropolitan Area	Hiromitsu Mori; Alyas WIDITA	Japan International Cooperation Agency
PP4205	On-Road Pollution Exposure in Multiple Transport Micro-Environments: A Case Study of Tier 2 & Tier 3 Cities in India	Kapil Meena; Ranjana Kumari; Arkopal Goswami	Indian Institute of Technology Kharagpur
PP4326	The Spread of TOD and the Impact of Covid-19 in Southeast Asia	Fumihiko Omori	Institute of Science Tokyo

ATTENTION

ADDITIONAL INFORMATION

If you find that your name is not listed, or there is an error in your data, please access the following link to check our last updated version.

uns.id/Latest-Update-16th-EASTS

SIDE EVENT

The side event serves as a multi-stakeholder forum that brings together government, private sector, academia, and civil society to exchange views and provide inputs on sustainable transport. It offers an open platform for sharing best practices, discussing policy directions, and exploring collaborative opportunities. By bridging perspectives from public and private actors, the session aims to generate constructive recommendations and strengthen partnerships that support the transition towards inclusive, low-emission, and sustainable mobility.

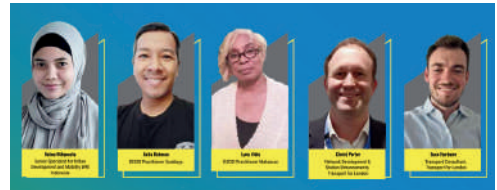

- 1.Strategy for Expanding Digital Payment Systems in Public Transport Services in Indonesia, **2 September 2025, 09.00-11.00 WIB**
- 2.Enhancing Indonesia's Urban Climate Resilience through Sustainable and Inclusive Transport, **2 September 2025, 11.00-13.00 WIB**
- 3.Strategy for Implementing Safety Management Systems in Public Transport Companies toward Safer Mobility, **2 September 2025, 14.00-16.00 WIB**
- 4.Strategy for Developing Environmentally Friendly Transport toward Sustainable Mobility, **3 September 2025, 10.00-12.00 WIB**
- 5.Book Review: Divine Transportation — Theory, Facts, Approaches, and Solutions, **3 September 2025, 13.30-15.00**



KIRAB BUDAYA

STAEG LAYOUT NGARSOPURO Capacity of tent: maximal 120 pax



 **Car Free Day,
Surakarta**

 **31 Agustus 2025**

A cultural parade **displaying traditional vehicles, cultural dances, and future transportation design concepts, illustrating the harmony between heritage and modern mobility.** This event highlights how cultural elements can be integrated into urban transportation planning, fostering a unique identity for cities while promoting sustainable and inclusive mobility solutions. With a vibrant showcase of creativity and innovation, **the parade serves as an inspiring platform to reimagine transportation systems that honor tradition while embracing the future.**

TIME	ACTIVITY
06.00-06.30	Participants of the EASTS 16 Delegation Carnival arrive at Gandrung Plant, Register, receive merchandise and heritage tours served marrow porridge and Solo oplos tea
06.30-07.00	Participants of the Delegation Carnival were departed to the Ngarsopuro Honor Stage with Reog, Costume Arts, Flag Bearer/Country Name
07.00 – 07.15	The Delegation Kirab was received by MTI and the Mayor of Solo. Presented by the Welcoming Dance
07.15- 08.00	Remarks by the Mayor of Surakarta Delegation Introduction, Info About EASTS conference events
08.00 – 08.30	Marching Band of Indonesian Railway Polytechnic Madiun, Closing, Participants return to the Hotel

GALA DINNER



Taman Balekambang, Solo

**19.00 -21.00 WIB
01 September 2025**

A networking dinner **bringing participants together in a relaxed setting to expand professional connections and foster meaningful collaborations.** The event also **features captivating cultural performances** showcasing Surakarta's rich heritage, creating a vibrant atmosphere where **tradition meets innovation.** With an engaging blend of dialogue, entertainment, and local flavors, this evening offers a **memorable experience** that strengthens professional ties while celebrating the city's cultural identity.

LAYOUT GALA DINNER Capacity: 240 pax Round Table

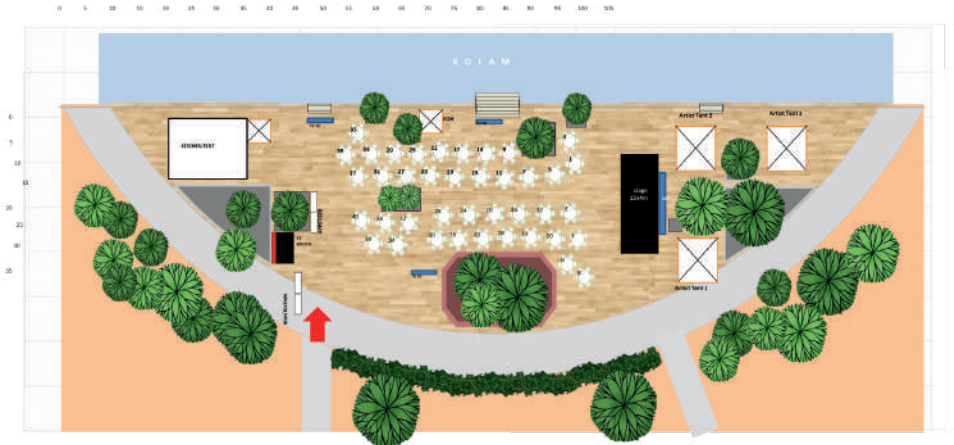



16th EASTS CONFERENCE 2025

OUR CONTACT



mstp@eastst.info



eastst.info/isc/
mti.or.id/en/16th-eastst-conference



Dr. Alfa Narendra, S.T., M.T.
Sekretaris Organizing Committee the 16th EASTS International Conference
Telp. +62 853-8833-8658

Dedi
Kantor Humas dan Kerjasama
Universitas Sebelas Maret
Telp/fax : +62 271 633961



+62 821-2574-1233 (MTI Pusat)



JB Tower Lantai 10, Jalan Kebon Sirih
No.48-50, Gambir, Jakarta Pusat,
Daerah Khusus Ibukota Jakarta 10110